

COMUNE DI PRATO

PIANO DI RECUPERO N.392 IN ATTUAZIONE DELLA AT4b\_01  
EX LANIFICIO ROSATI, VIA PISTOIESE, 365 ANGOLO VIA DELL'ALBERACCIO, 2-4

RZ 02

DOCUMENTAZIONE FOTOGRAFICA



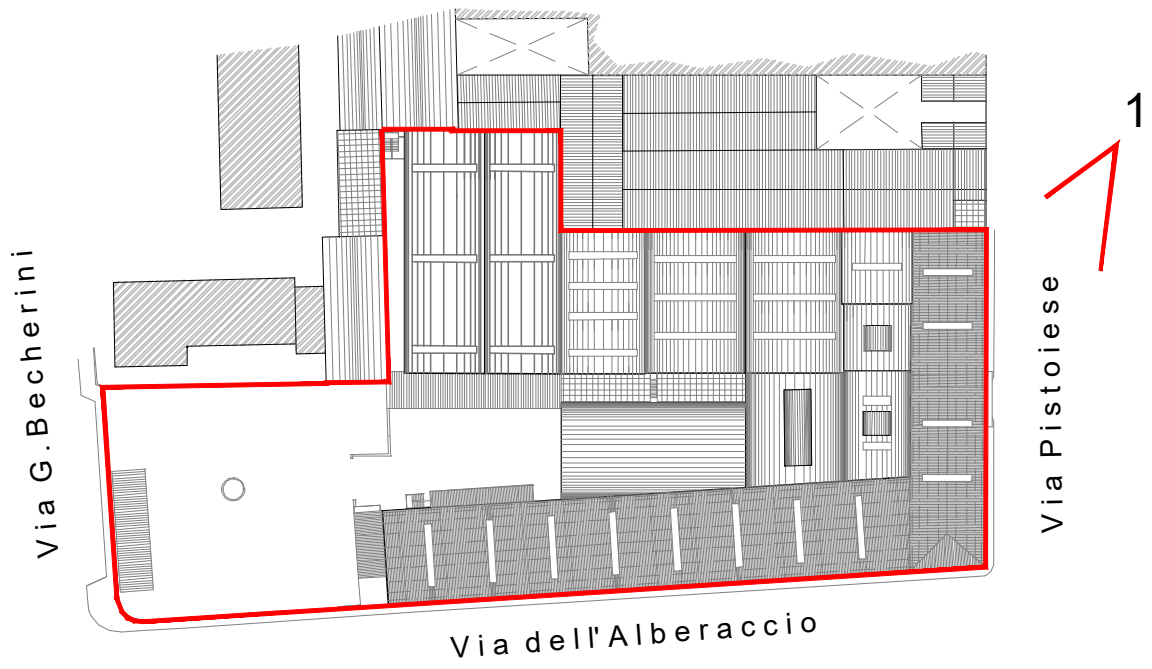

1



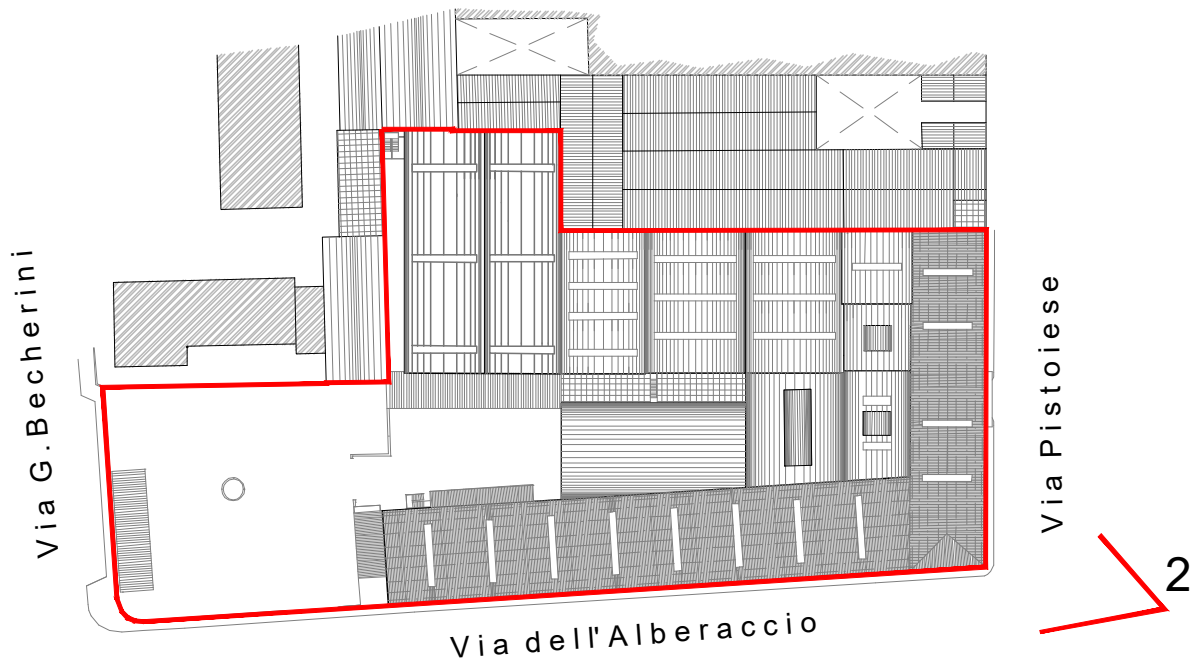

2



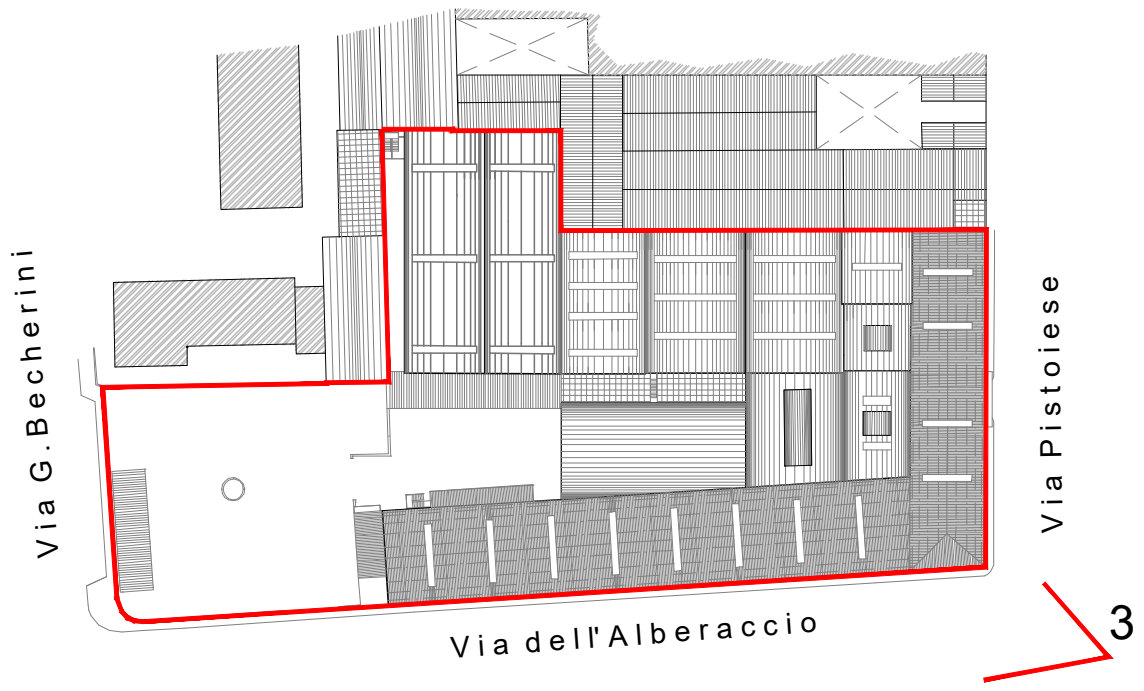

3



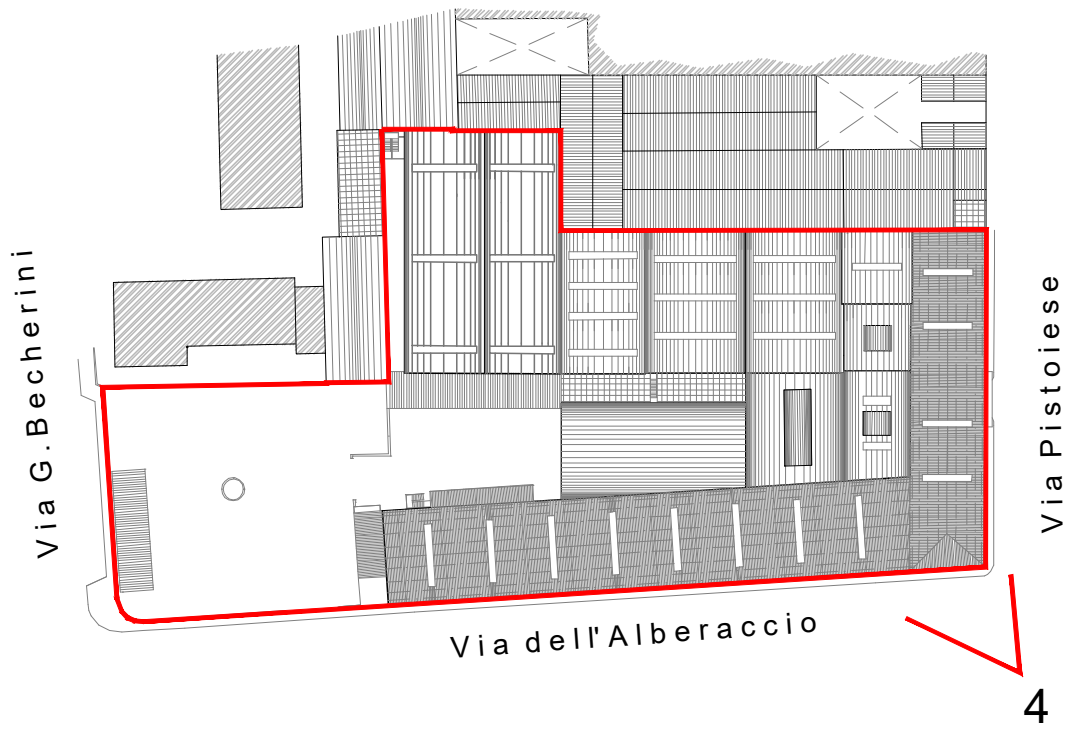

4



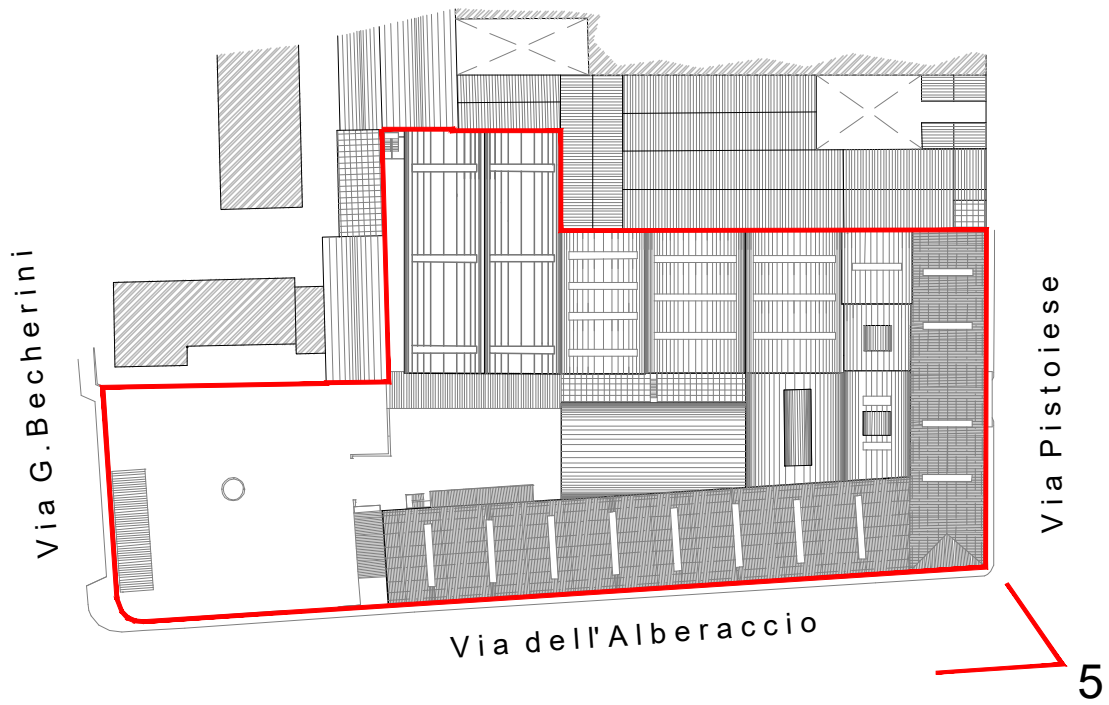

5



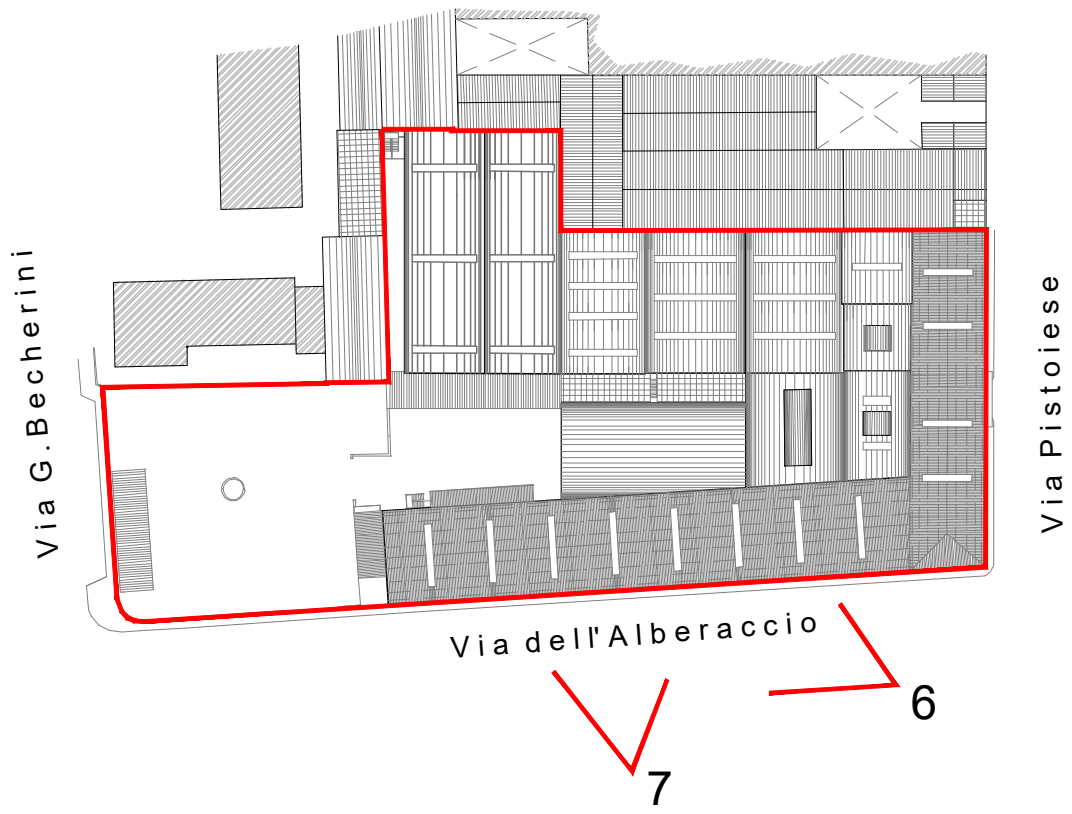

6



7



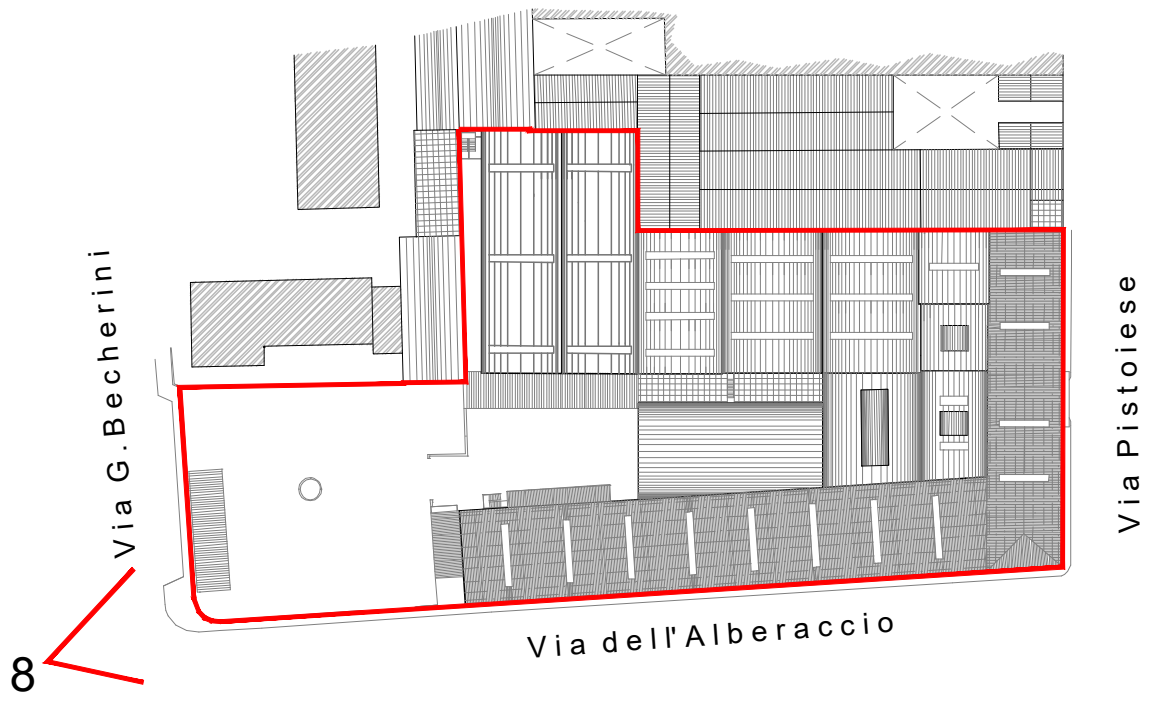

08





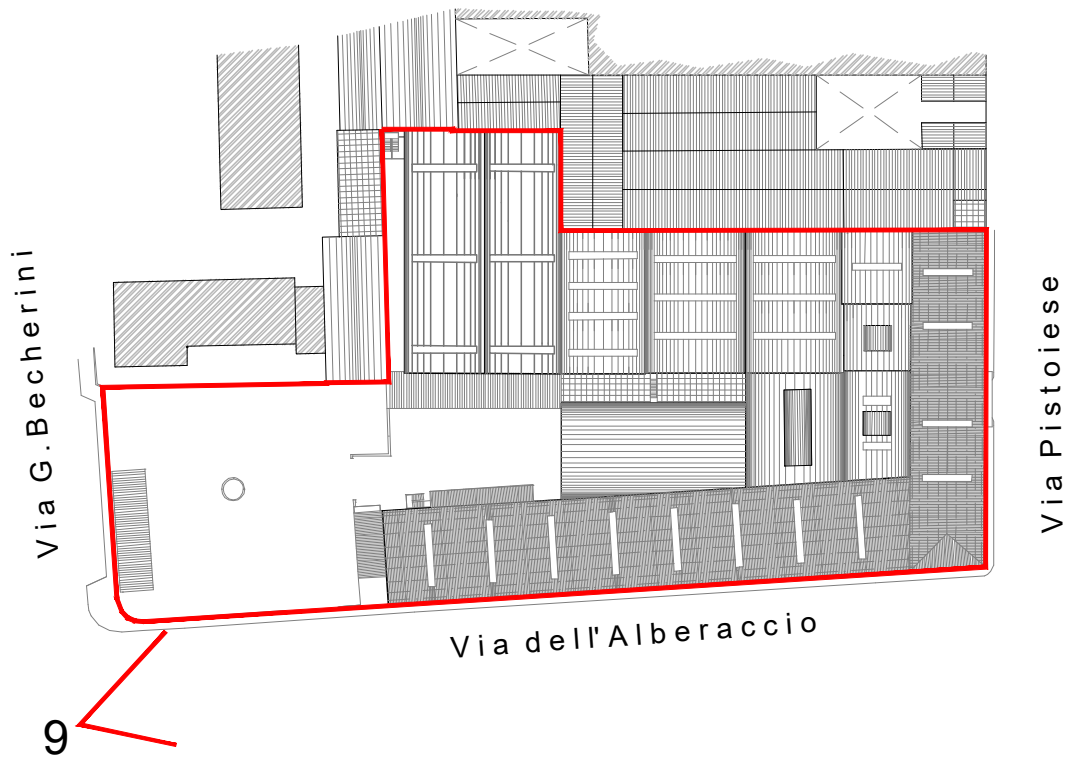

9



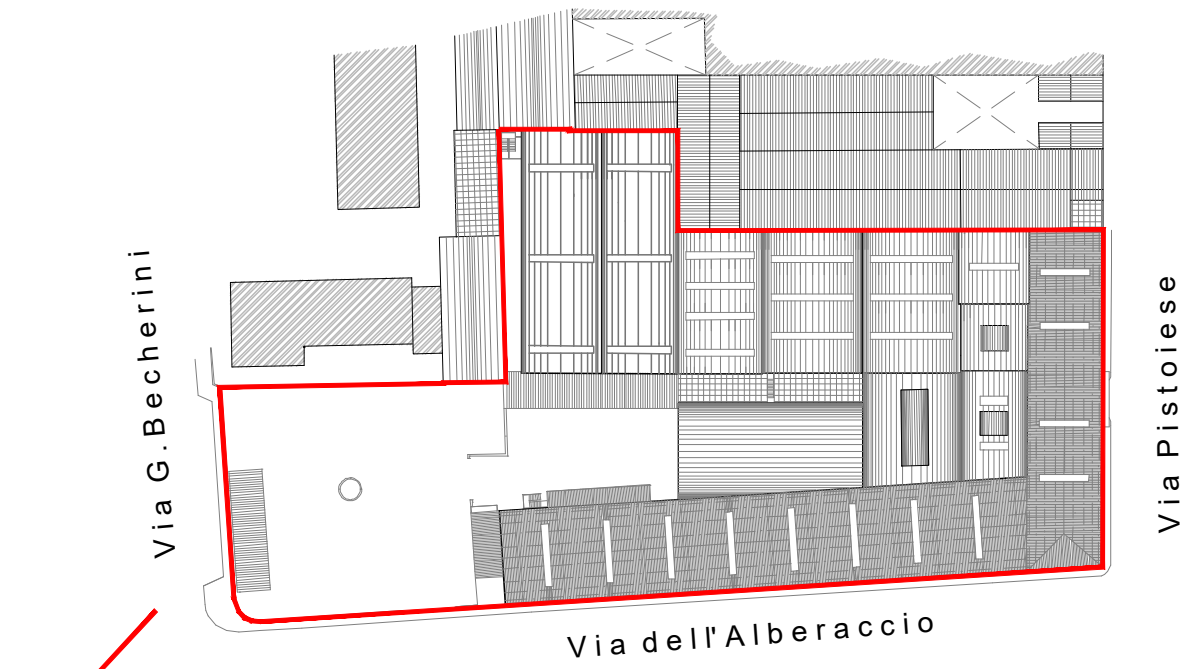

10

10

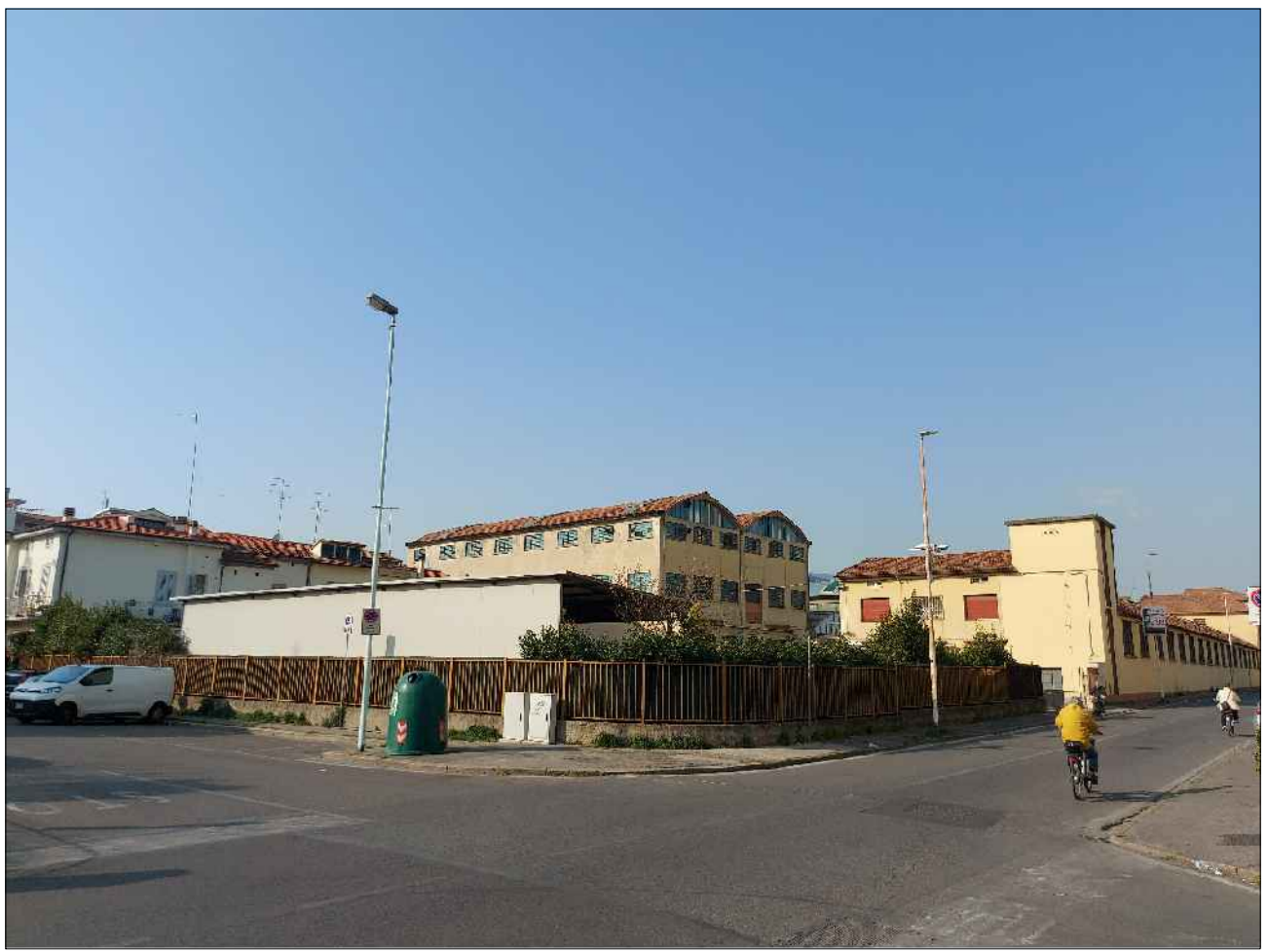

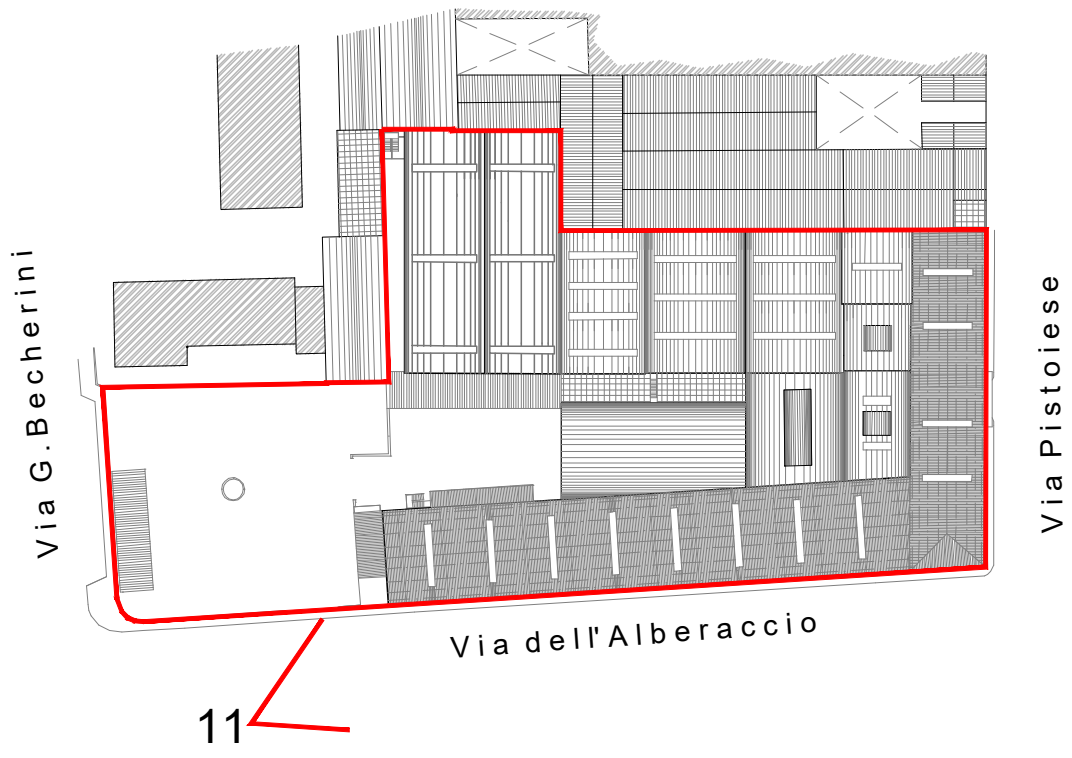

11



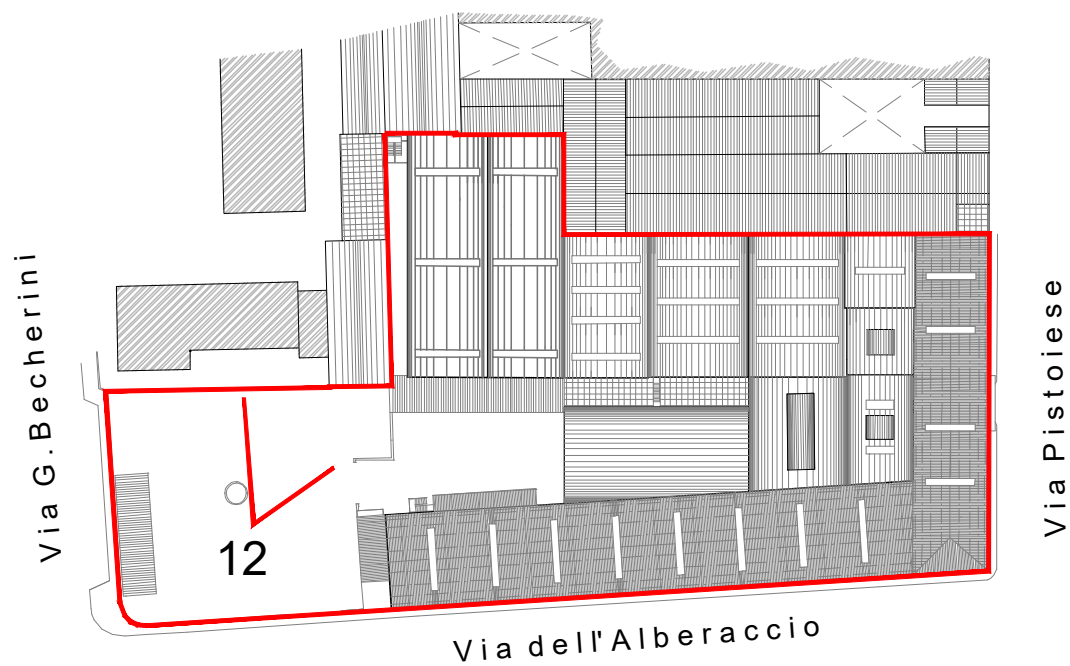

12



SCORCIO DELL'EDIFICIO A TRE PIANI DAL PIAZZALE PREVISTO IN CESSIONE  
TRA LA VIA BECHERINI E LA VIA DELL'ALBERACCIO

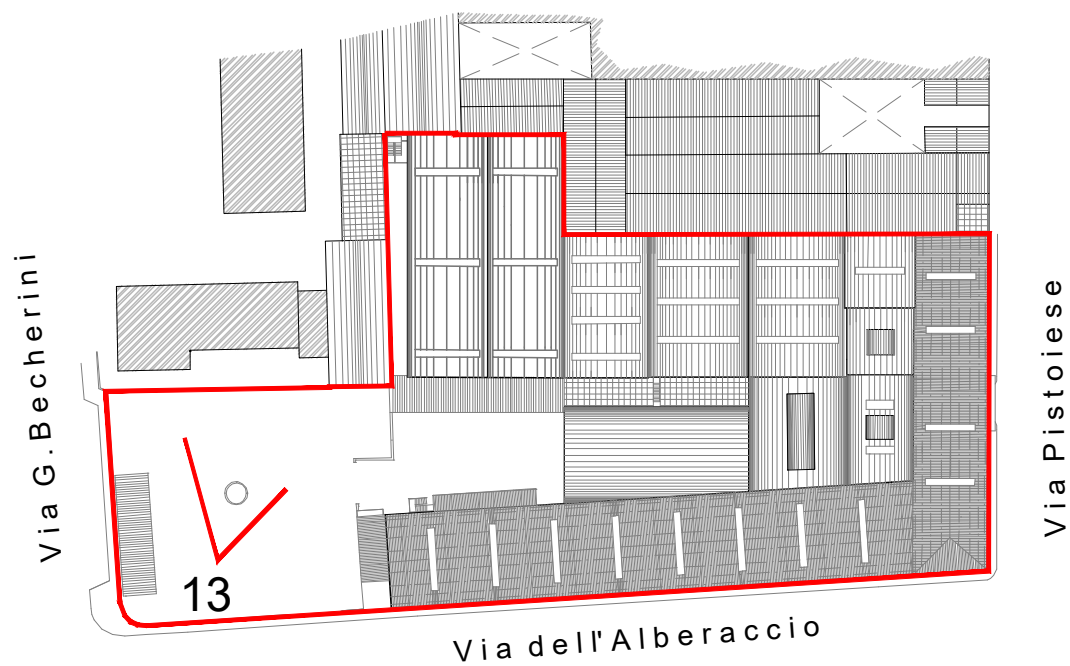

13



VISTA DI EDIFICI CONFINANTI DAL PIAZZALE PREVISTO IN CESSIONE  
TRA LA VIA BECHERINI E LA VIA DELL'ALBERACCIO

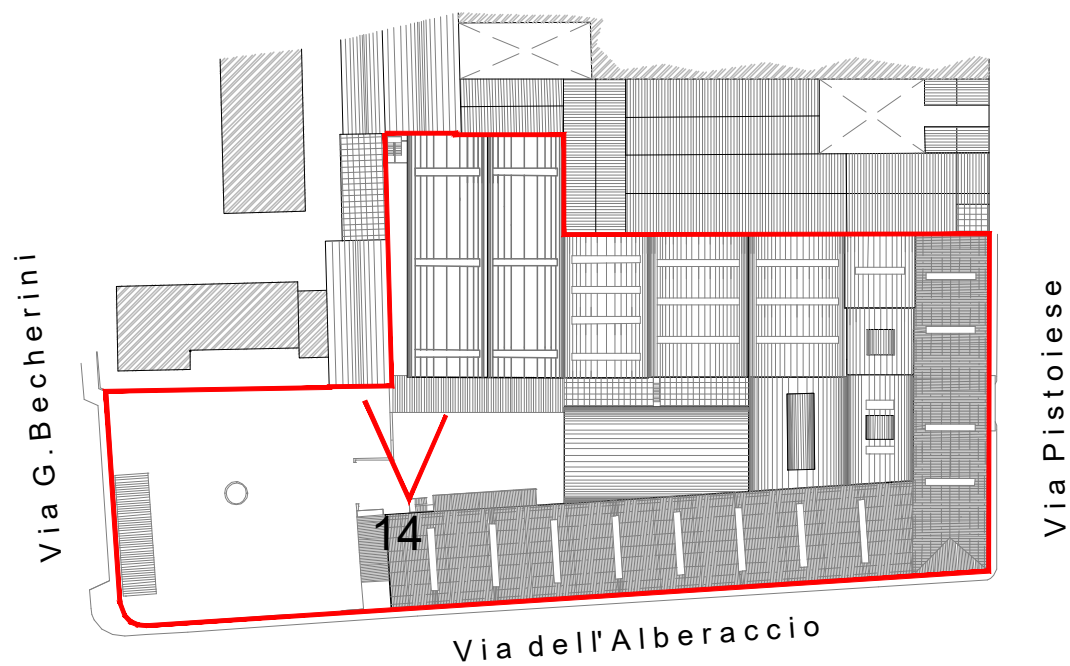

14



SCORCIO PROSPETTO LATERALE SINISTRO DELL'EDIFICIO A TRE PIANI DAL PIAZZALE PRIVATO

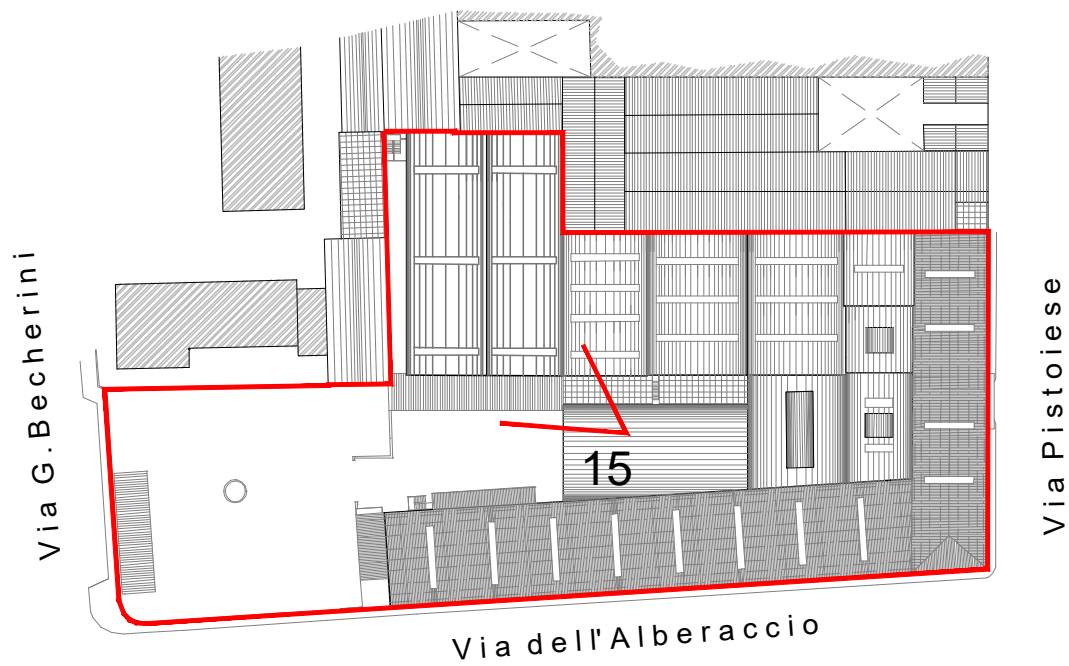

15



VISTA FRONTALE DELL'EDIFICIO A TRE PIANI DAL PIAZZALE PRIVATO

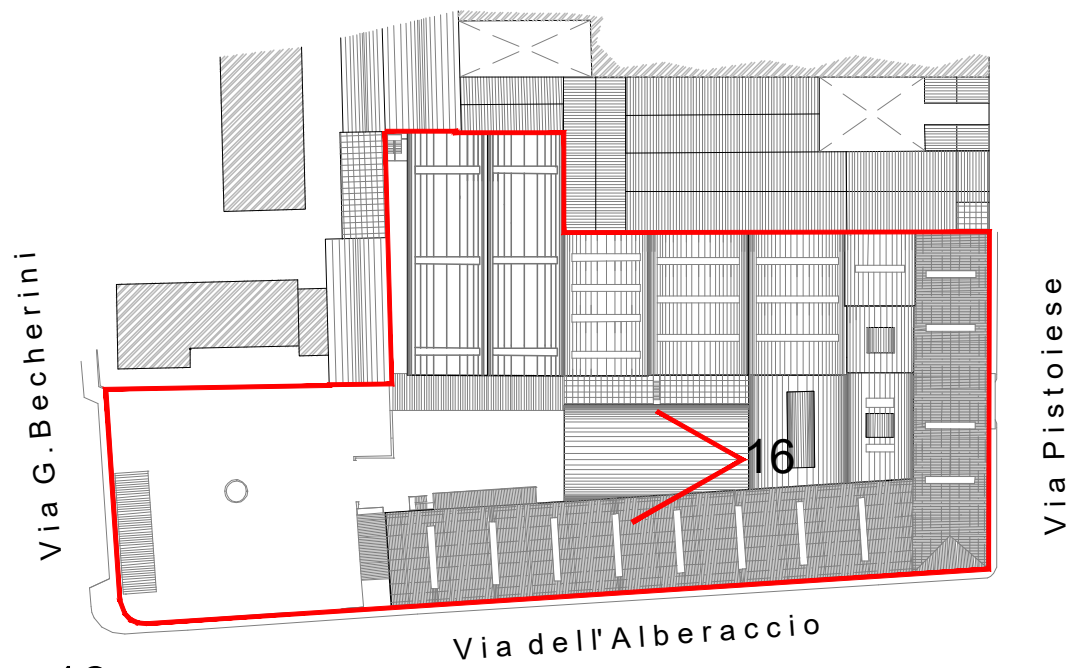

16



VISTA DEL PIAZZALE PRIVATO DAL LATO VIA PISTOIESE



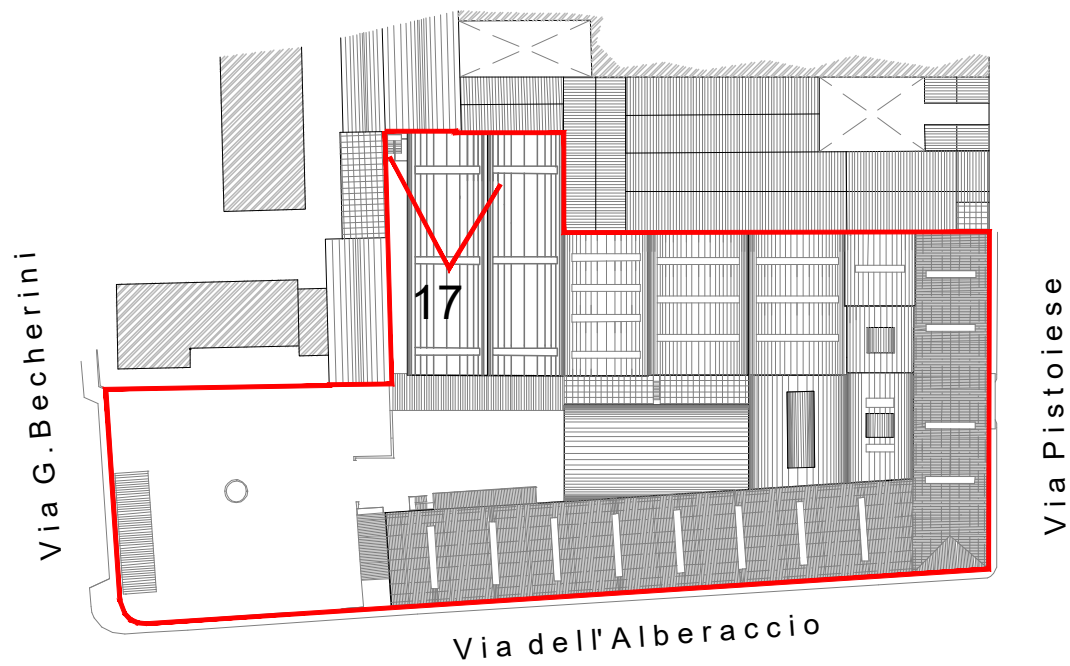

17



VISTA INTERNA DELL'EDIFICIO A TRE PIANI (PIANO SECONDO)

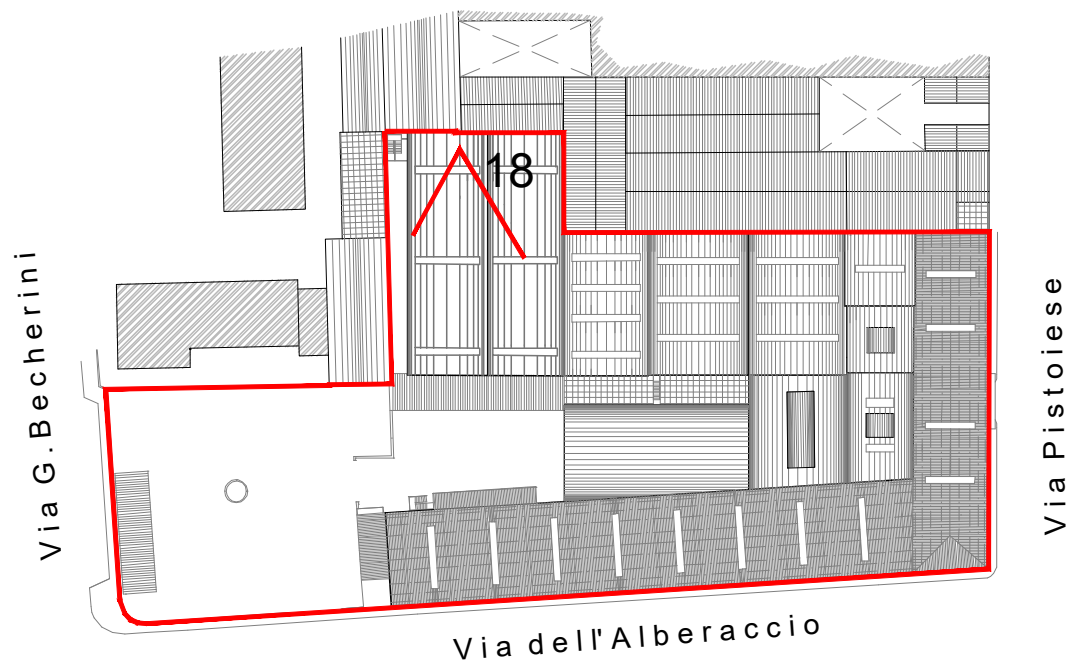

18



VISTA INTERNA DELL'EDIFICIO A TRE PIANI (PIANO SECONDO)

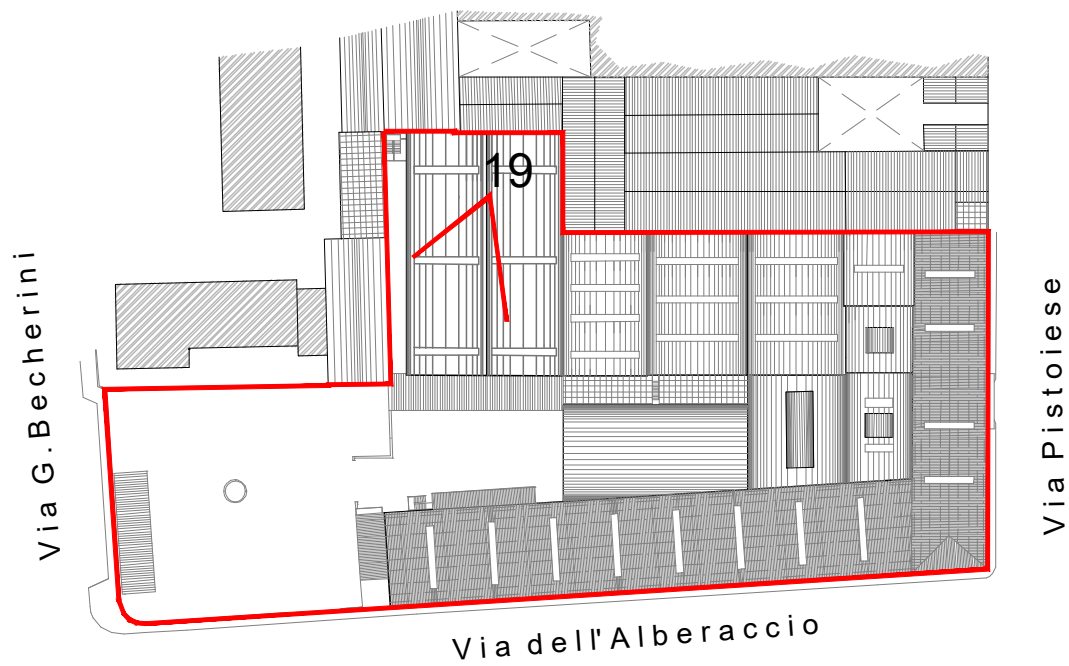

19



VISTA INTERNA DELL'EDIFICIO A TRE PIANI (PIANO SECONDO)

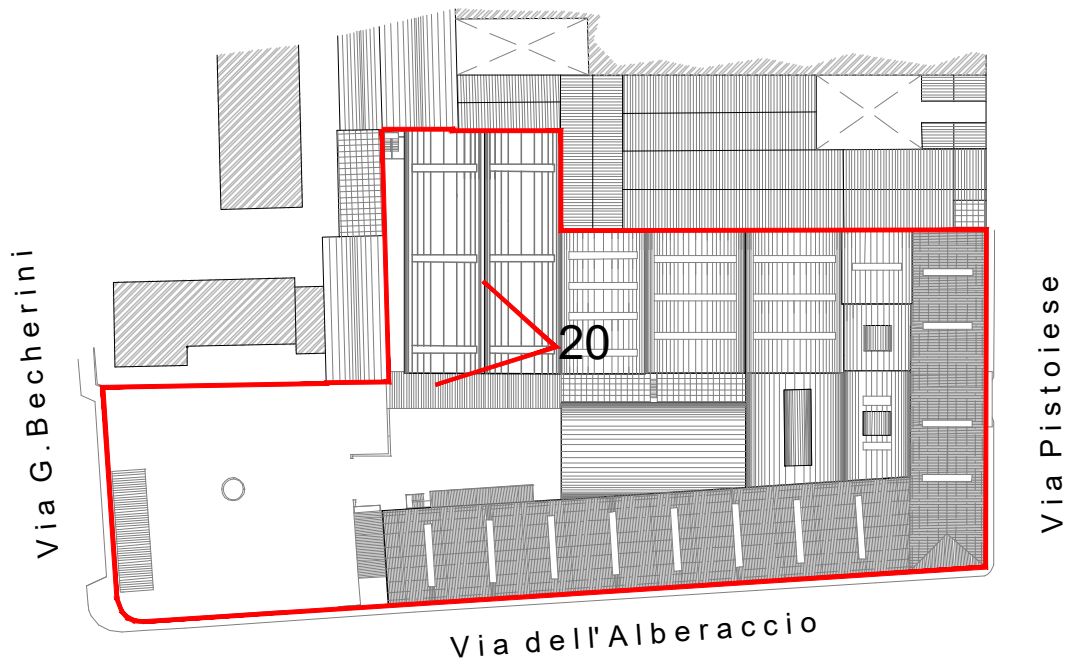

20



VISTA INTERNA DELL'EDIFICIO A TRE PIANI (PIANO SECONDO)

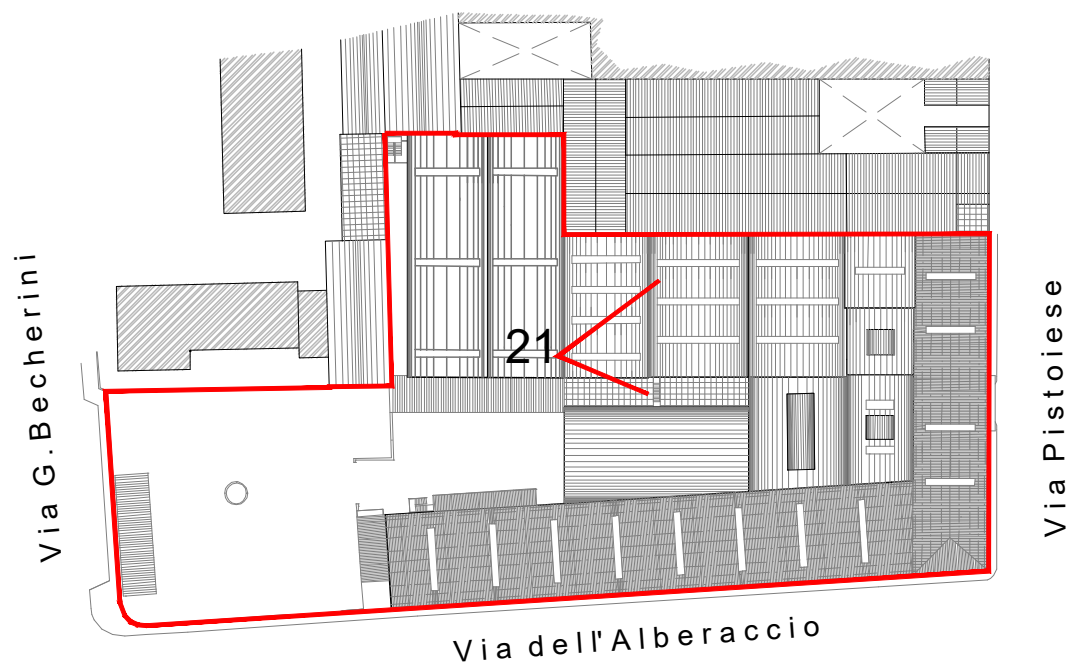

21



VISTA INTERNA DI PORZIONE EDIFICIO DA DESTINARSI A PARCHEGGIO PRIVATO COPERTO

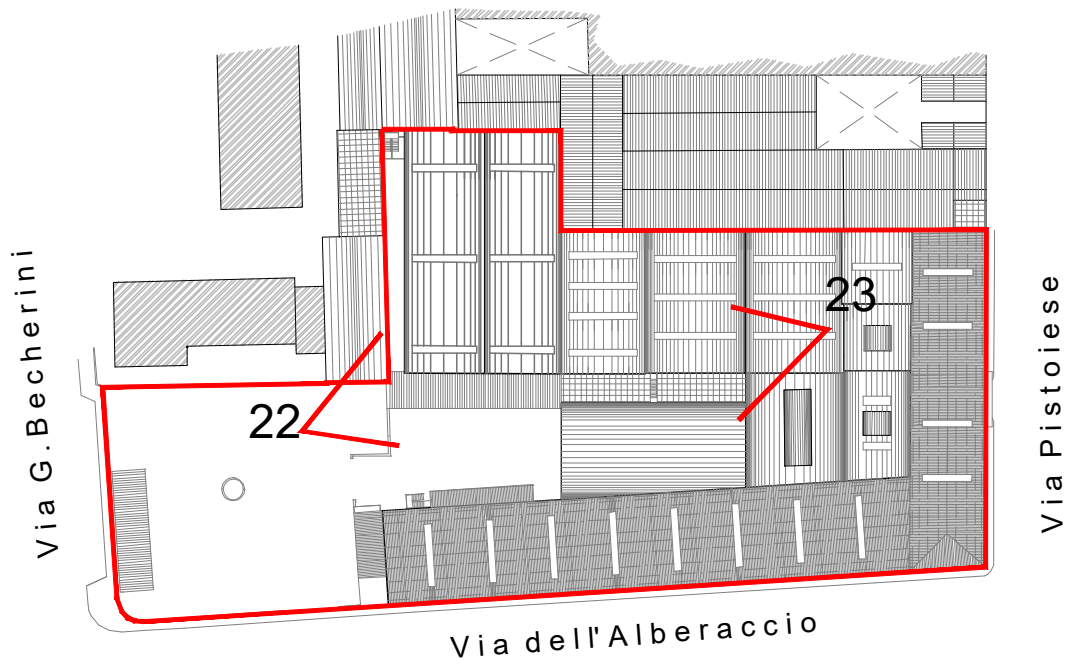

22



23



Firmato da:

**Oliva Bruno**

codice fiscale LVOBRN60E04L383U

num.serie: 7217746416240693051053069566141384427

emesso da: ArubaPEC S.p.A. NG CA 3

valido dal 23/12/2022 al 23/12/2025