

COMUNE DI PRATO

PIANO ATTUATIVO PER LA REALIZZAZIONE DI EDIFICI RESIDENZIALI
AREA DI TRASFORMAZIONE AT5_04

ubicazione: Via San Martino per Galceti - Prato

data: dicembre 2021 **REVISIONE 2**

TAV. EP 04

stato di progetto
conteggi urbanistici
calcolo superficie e volume fabbricati - scala 1:200
tabelle di verifica

proprietà: IMMOBILIARE MO BA s.r.l. con sede a Prato in via F. Ferrucci, 49 - c.f. P.I. 01538220979
legale rappresentante: Monzali Nadia.

progettisti: arch. Alessandro Corradini con studio in via del Cassero, 16 - 59100 Prato (mdu architetti)



sezione trasversale

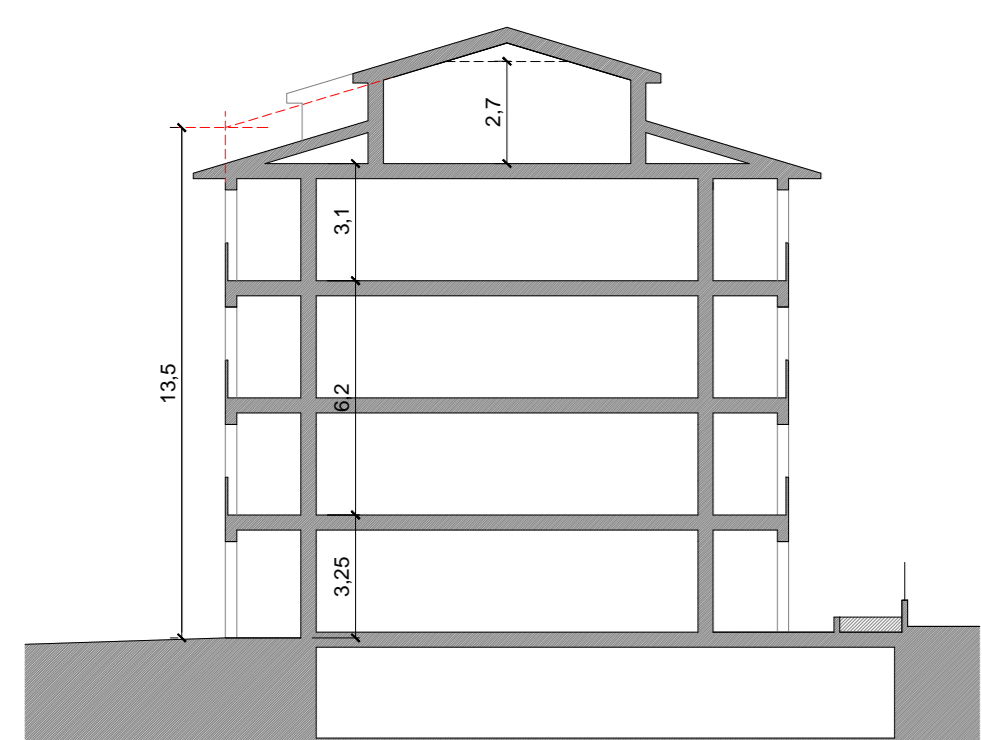

CALCOLO DELLA Se DI PROGETTO
3.090,28 mq

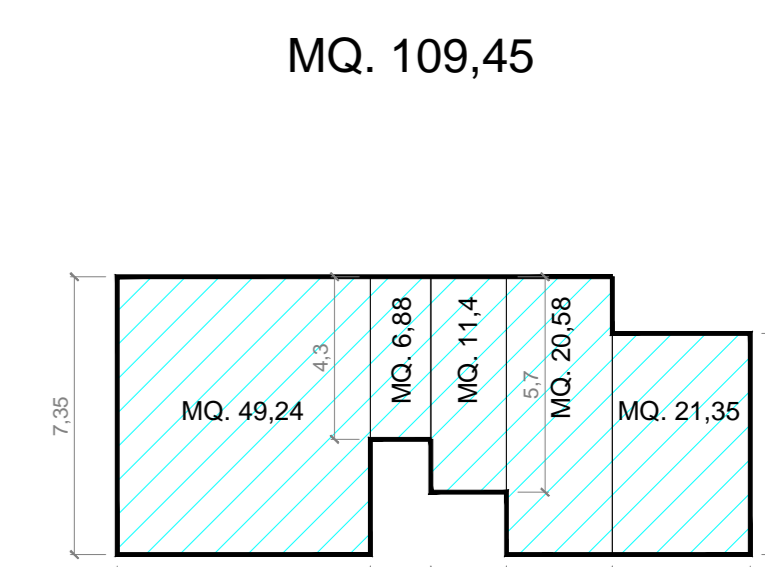
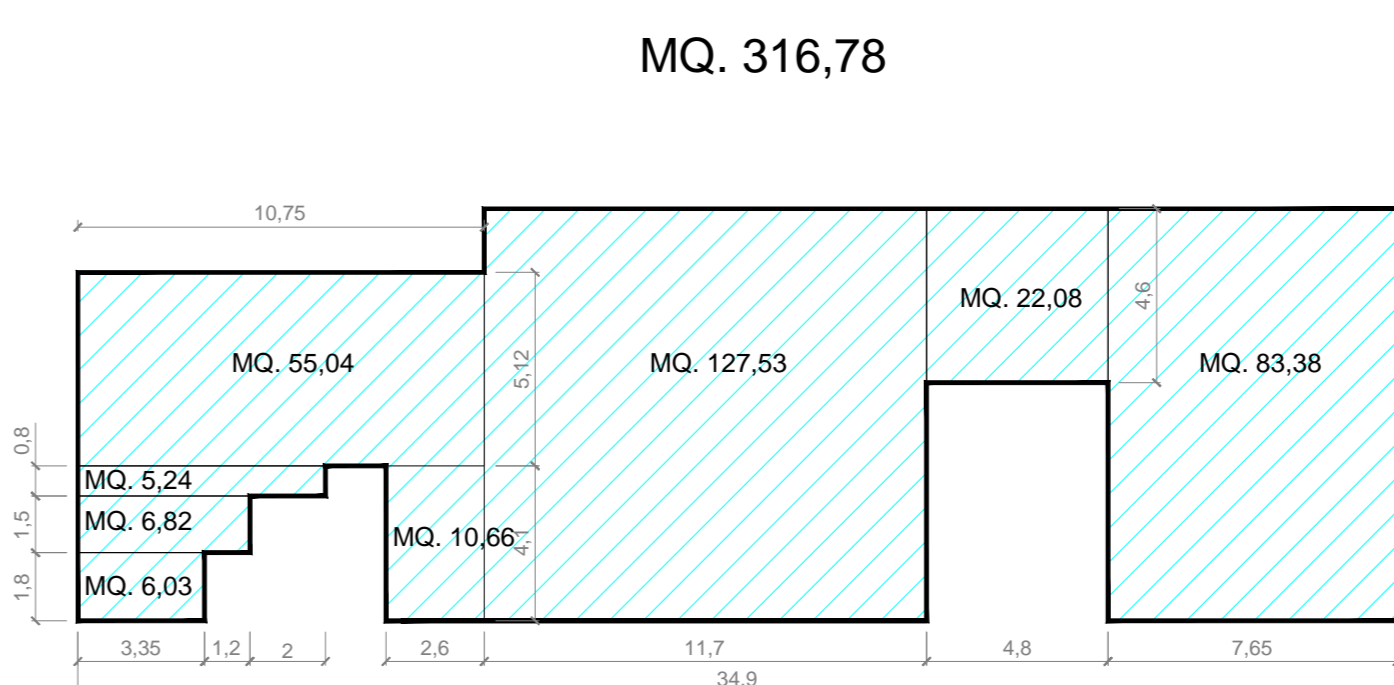
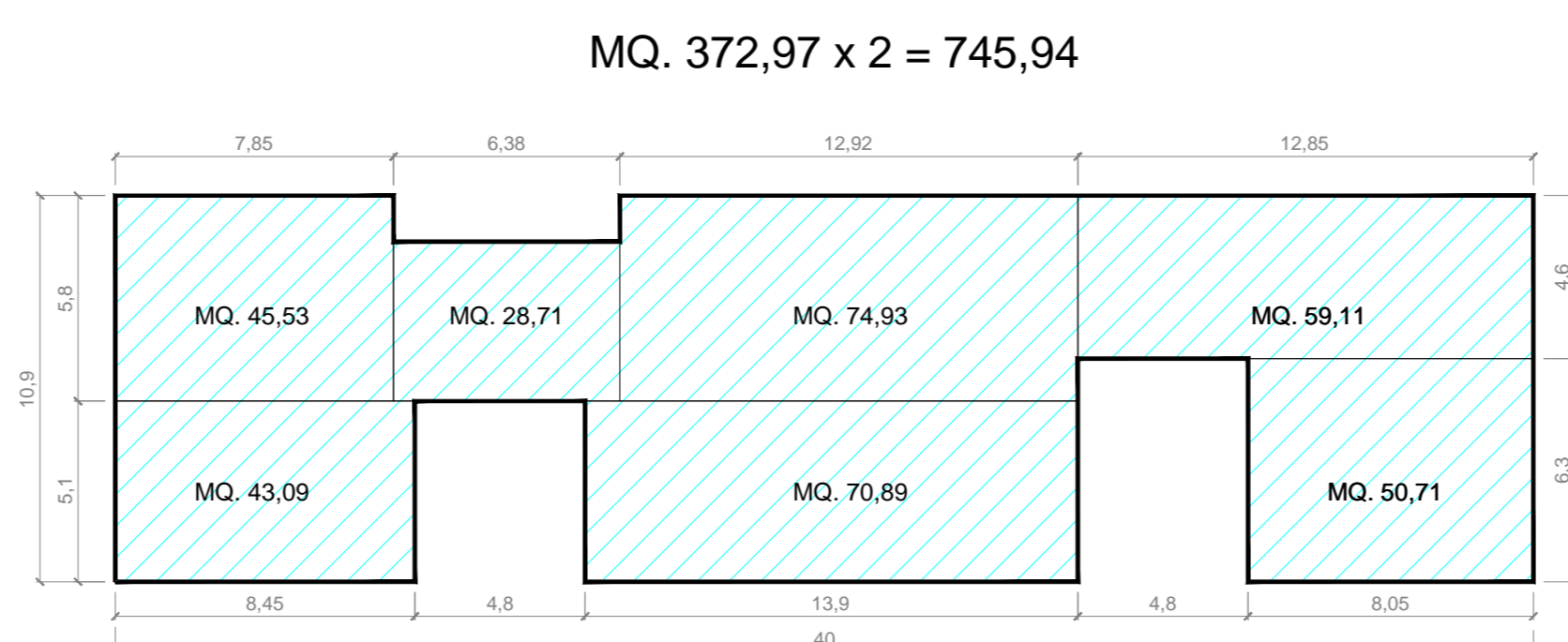
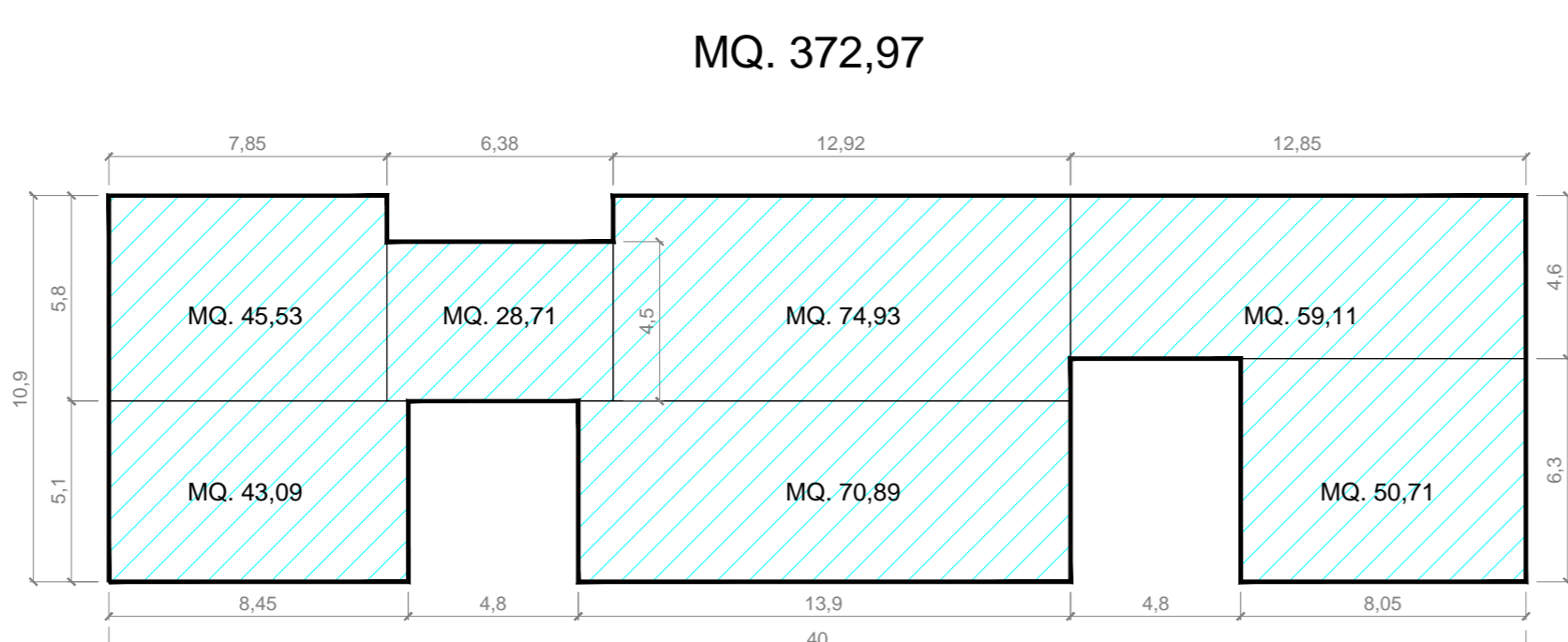
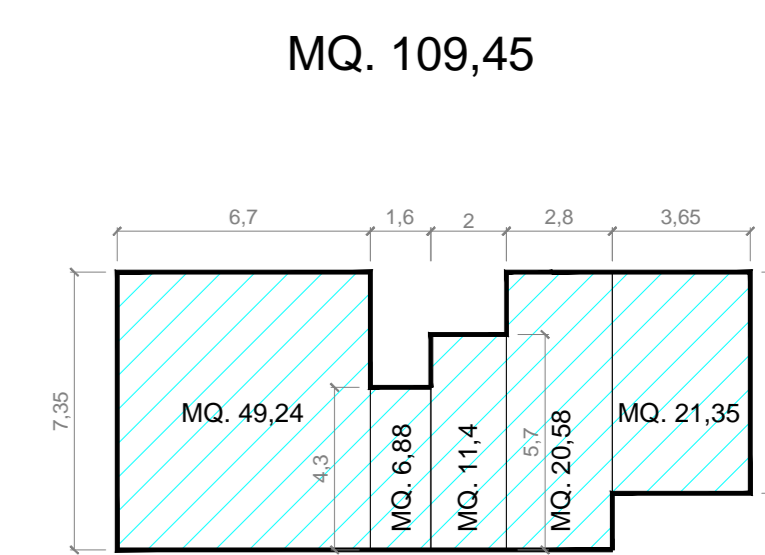
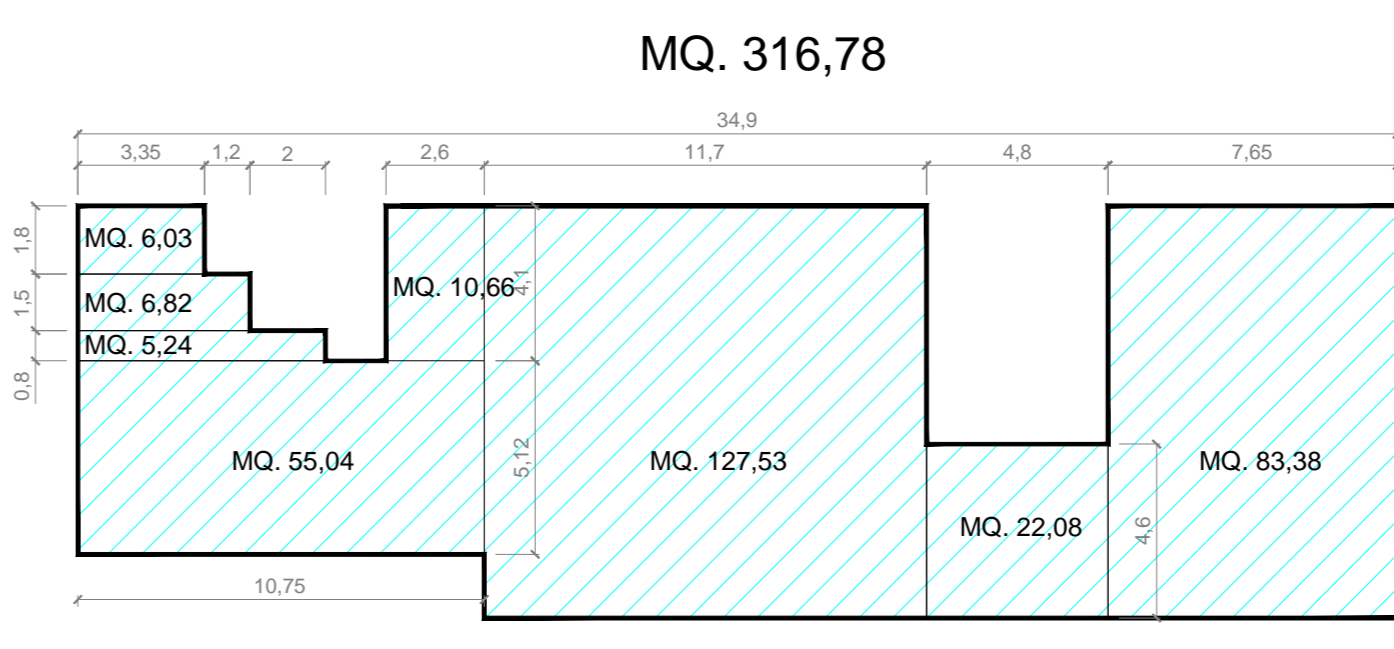
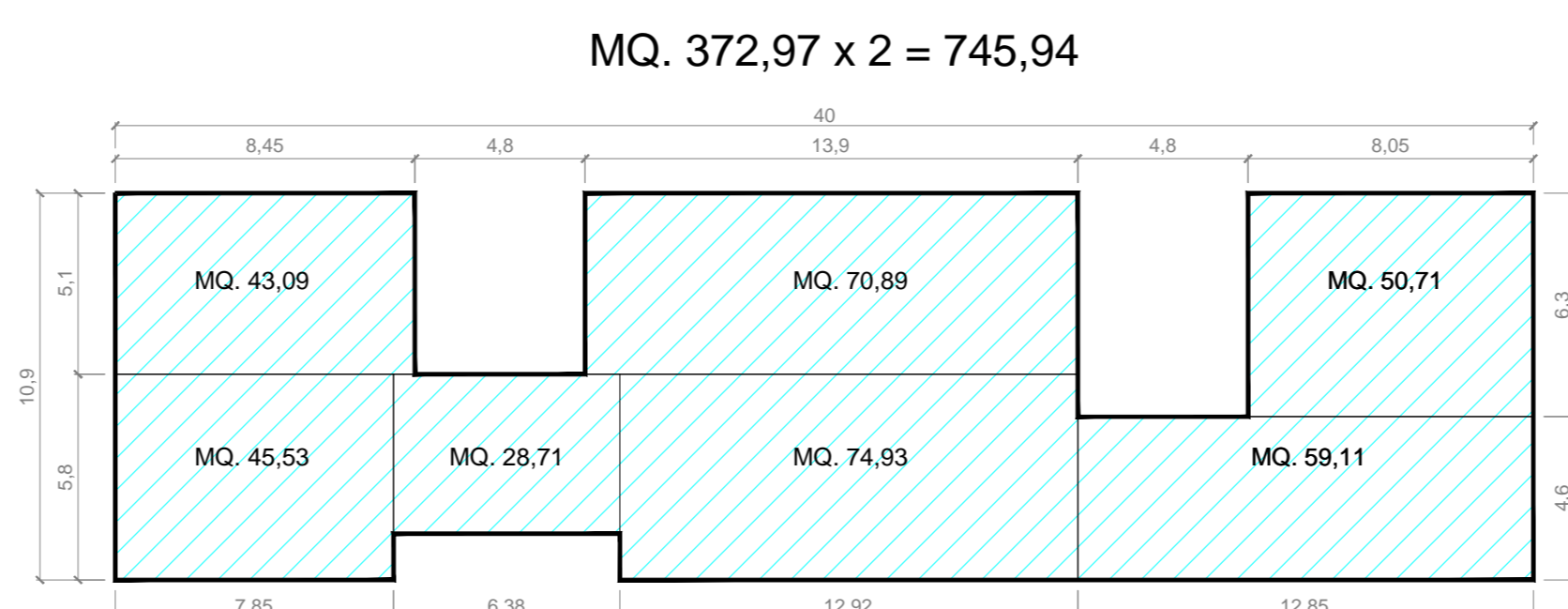
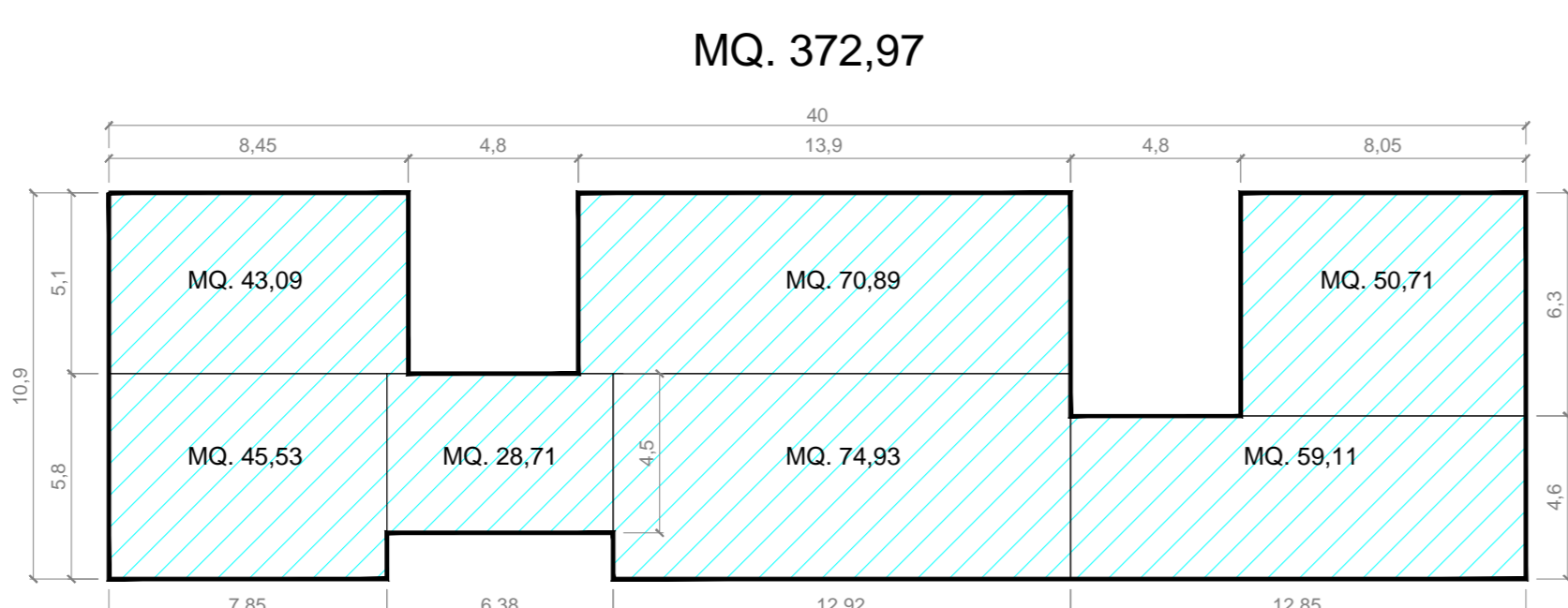

CALCOLO DEL VOLUME DI PROGETTO
10.963,12 mc

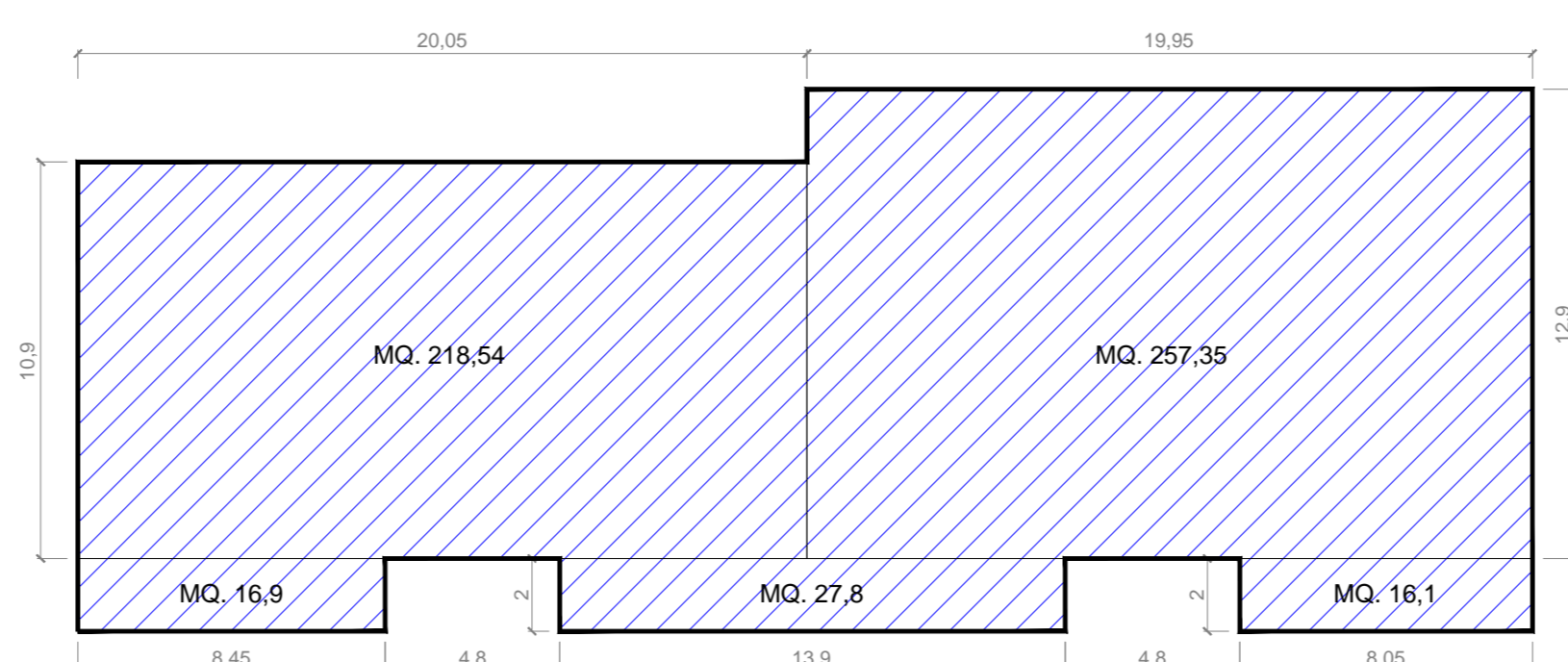
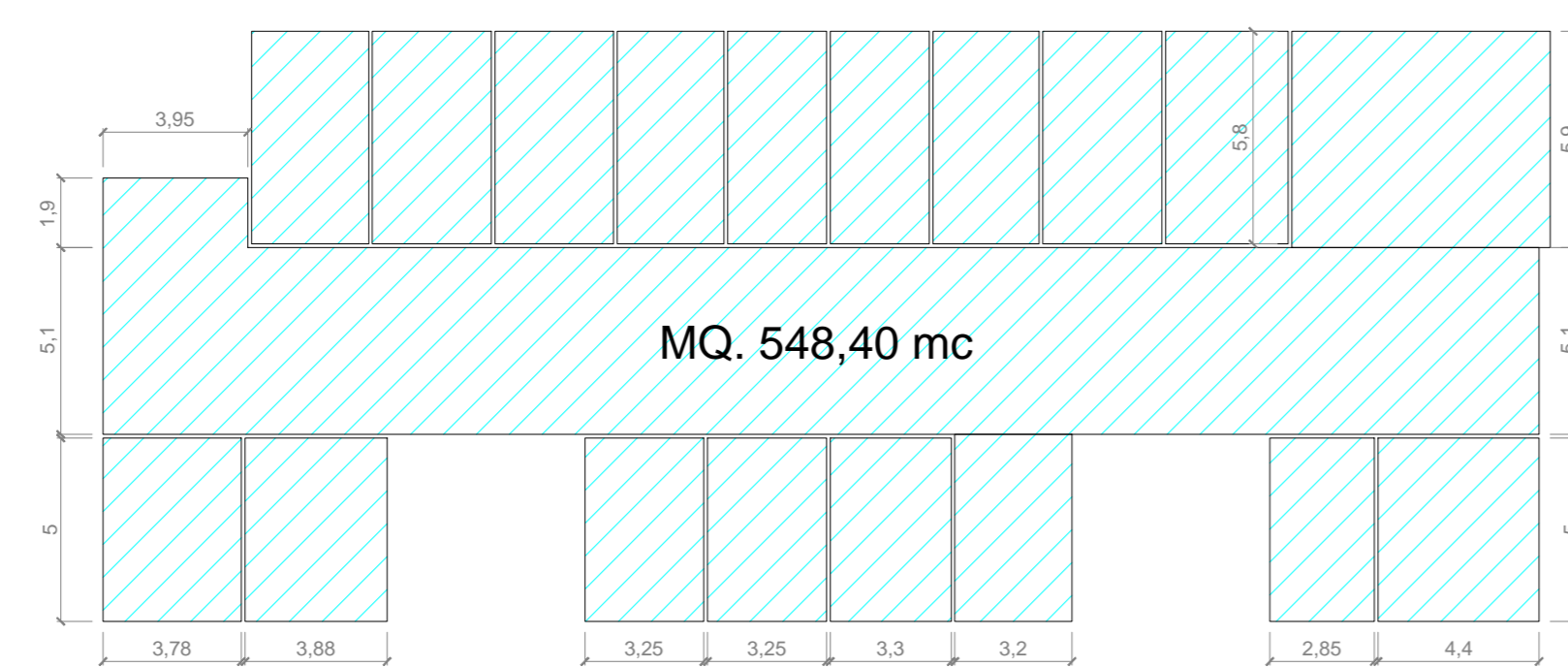
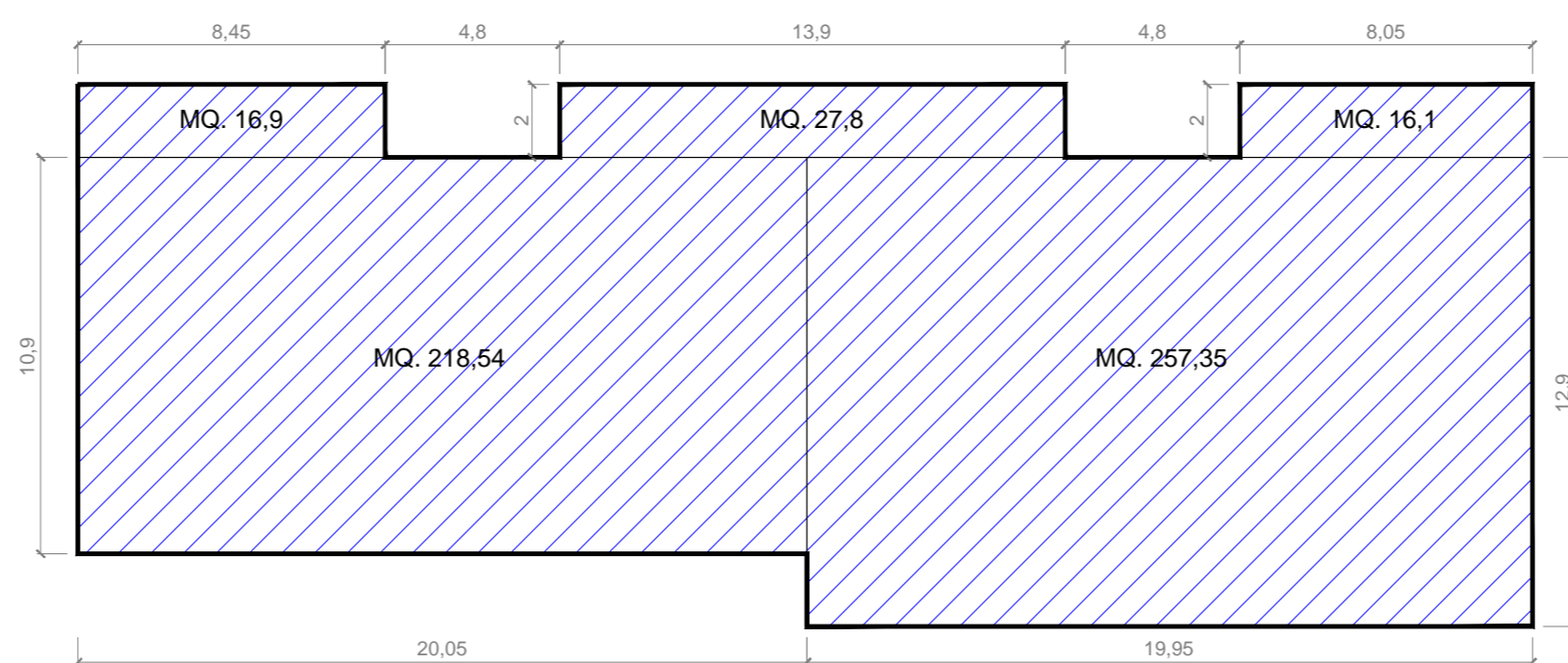
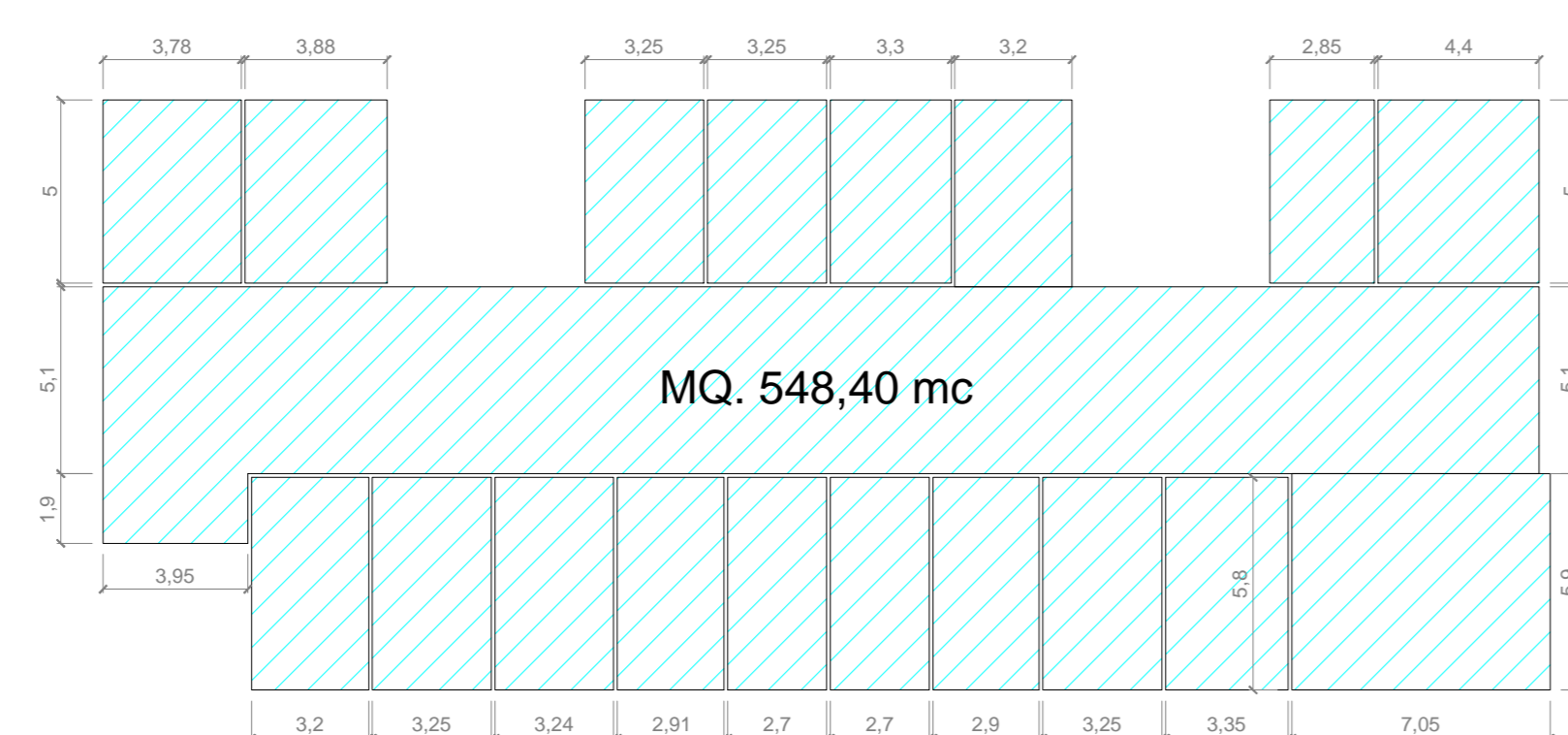
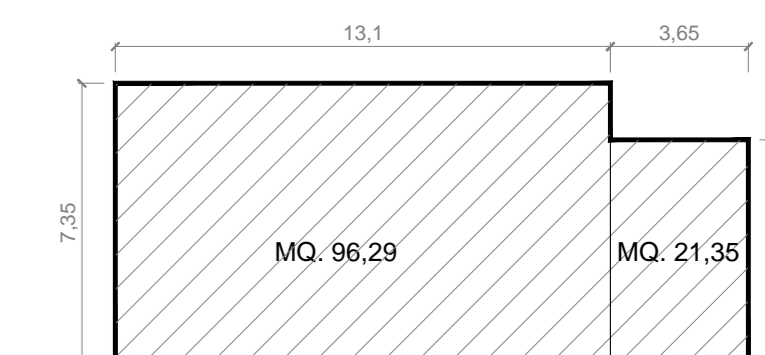
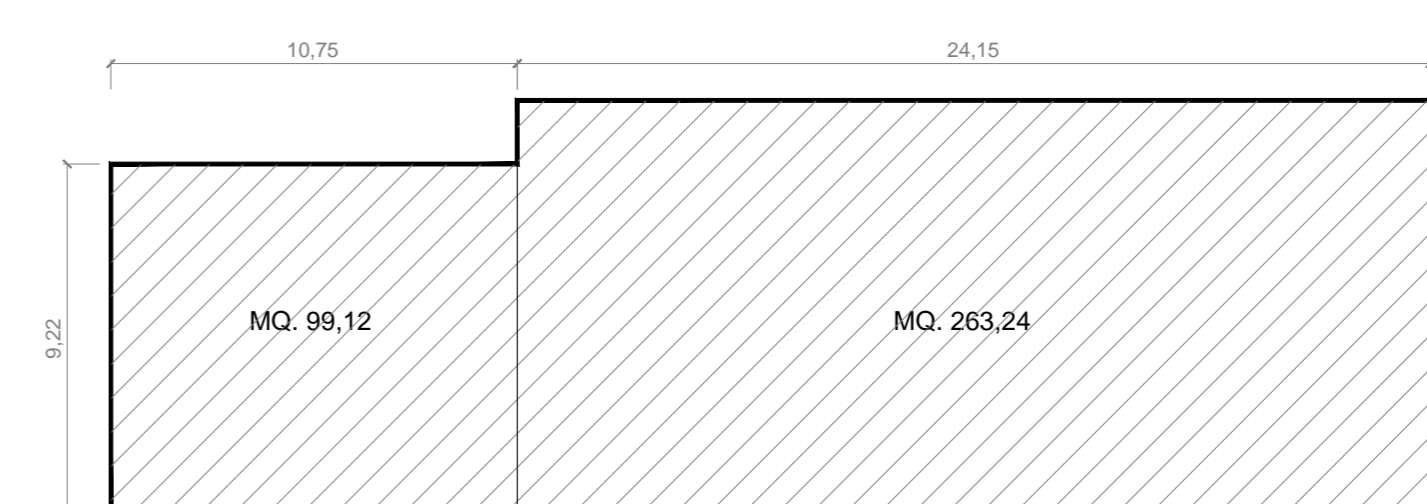
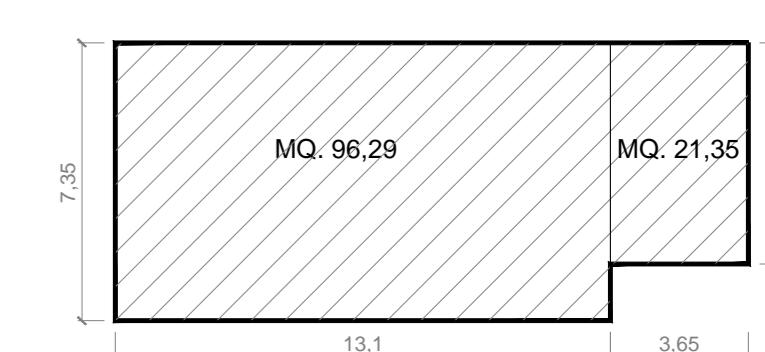
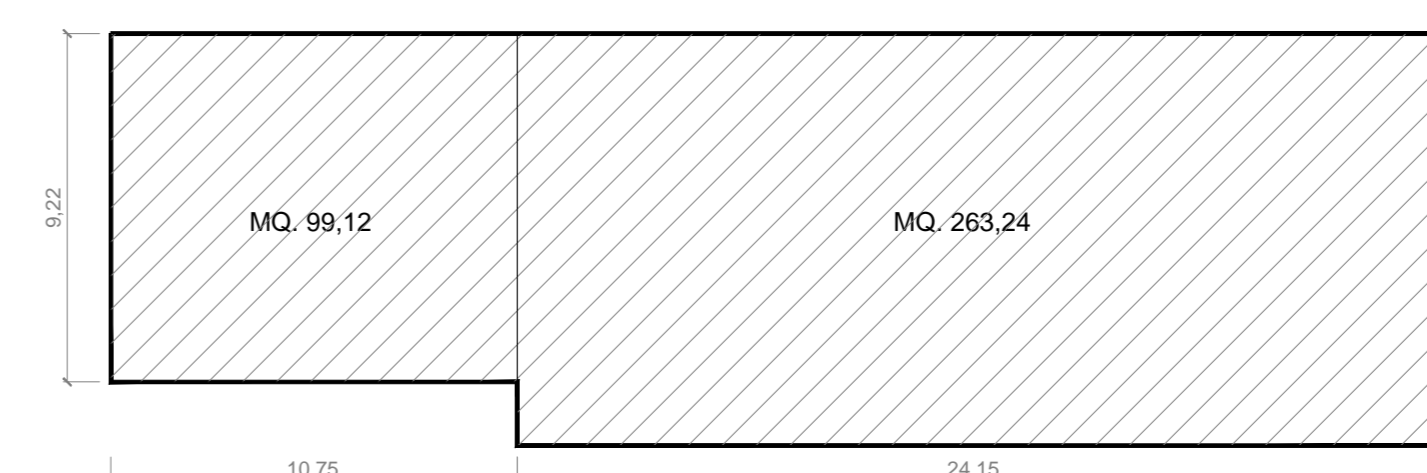
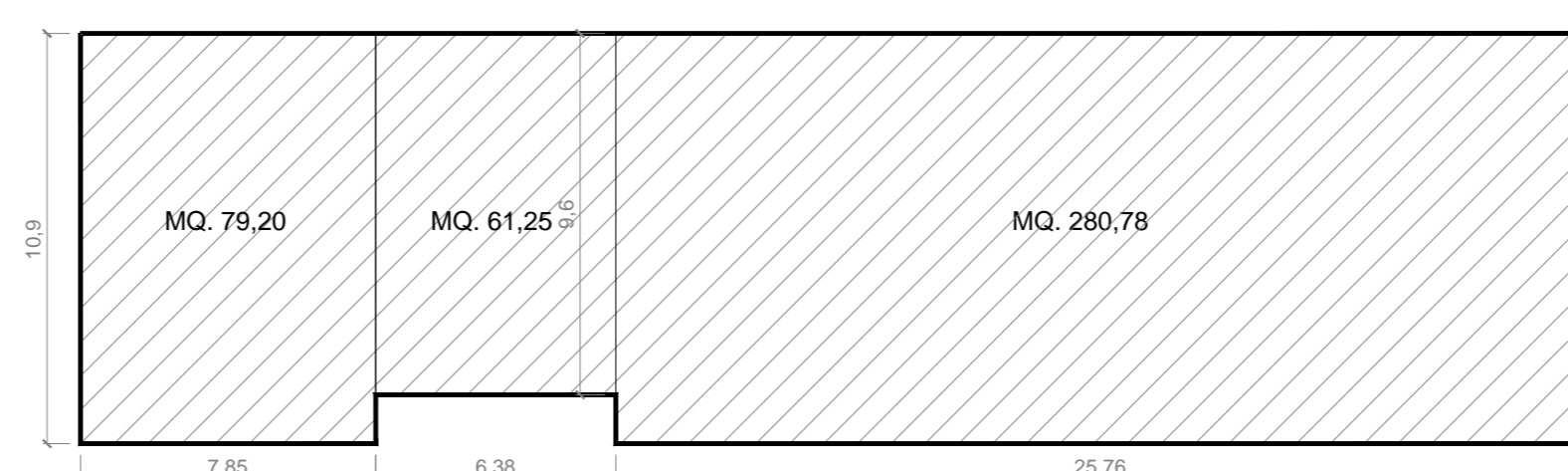
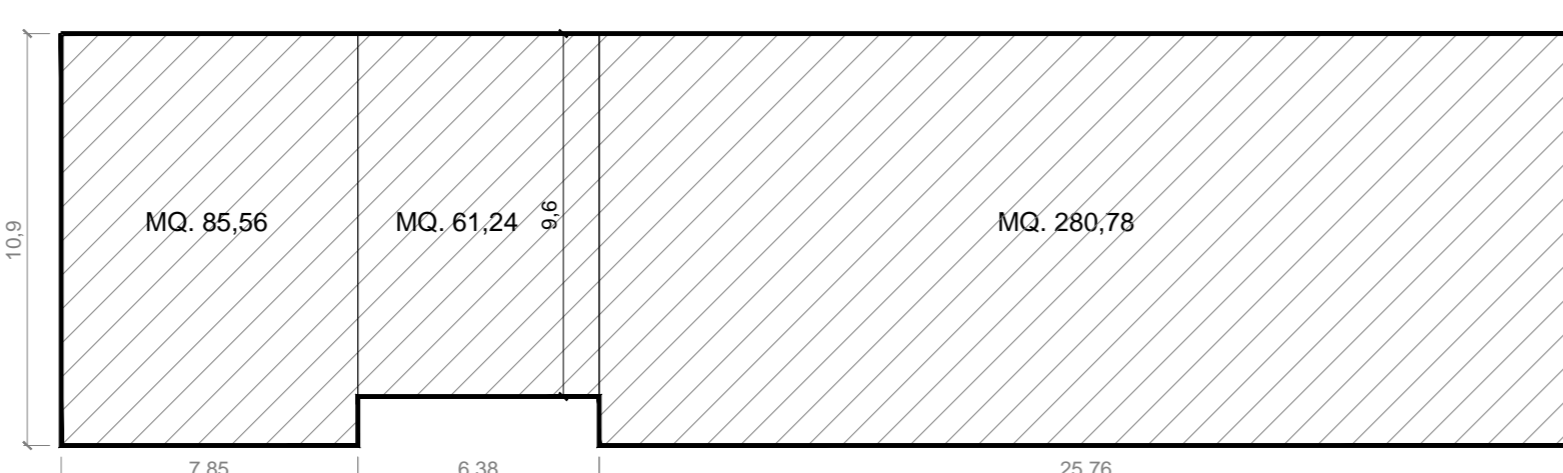

PIANO INTERRATO
MQ. (548,4 x 2) = 1.096,80

SUPERFICIE COPERTA
MQ. (536,69 x 2) = 1.073,38

quadro sinottico dei parametri urbanistici di progetto

PARAMETRI AREA DI TRASFORMAZIONE		
Superficie territoriale - ST	mq	15.637,0
Superficie del lotto fondiario - SF	mq	3.066,0
Superficie edificabile - Se	mq	3.100,0
Rapporto di copertura massimo - RC	%	50,0
Altezza massima - H	ml	13,5
Standard urbanistici (parcheggi alberati)	mq	1.543,0
Cessioni	% (ST)	64,0

PARAMETRI DI PROGETTO		
Superficie territoriale - ST	mq	20.774,30
Superficie del lotto fondiario - SF	mq	2.912,34
Superficie edificabile - Se	mq	3.090,28
Rapporto di copertura massimo - RC	%	36,85
Altezza massima - H	ml	13,50
Standard urbanistici (parcheggi alberati)	mq	1.603,48
Cessioni	% (ST)	71,29

ALTRI PARAMETRI DI PROGETTO		
Superficie nuova strada	mq	1.448,65
Superficie tot. urbanizzazioni (standard + strada)	mq	3.052,13
Superficie aree in cessione	mq	14.809,83
Superficie coperta	mq	1.073,38
volume edifici	mc	10.963,12
Superficie parcheggi L.122 (> 10.963,12/10 = 1.096,31 mq)	mq	1.096,80
Superficie aree permeabili (> 25% Sf = 728,08 mq)	mq	919,40

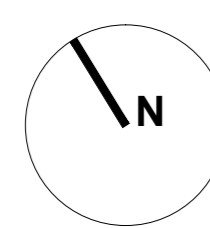

Firmato da:

corradini alessandro

codice fiscale CRRLSN64A17D612Y

num.serie: 93563984920300697878435416073686539746

emesso da: ArubaPEC S.p.A. NG CA 3

valido dal 22/04/2020 al 23/04/2023