

PROGETTO: VARIANTE AL PIANO DI RECUPERO PDR 245 DENOMINATO
"VIA CURE" ISLANZA P.G. 120824 DEL 01.10.2009.

UBICAZIONE: VIA Marie Curie n°6, Prato

RICHIEDENTE: "IMPRESA EDILE SABRI"

ELABORATI: PIANTE

NOTE: CONTEGGI URBANISTICI VIA CURE

TAVOLA:
04/1

SERIE:
EP

SCALA:
1:200

DATA:
Novembre 2017

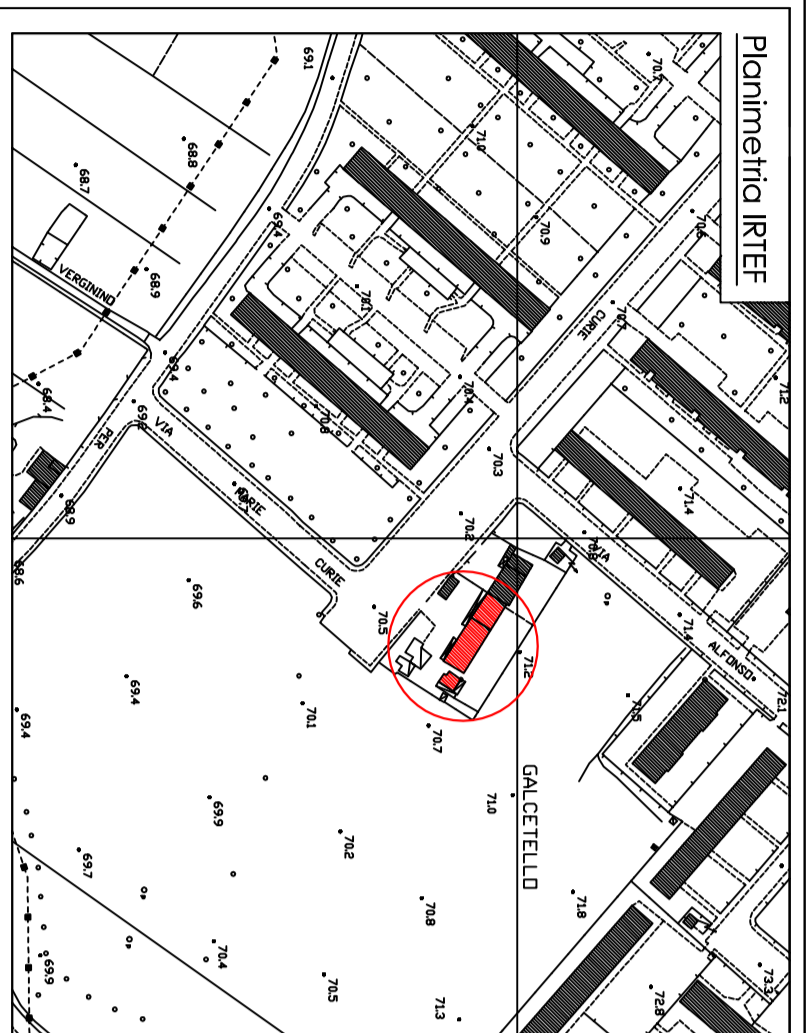

IL RICHIEDENTE: I TECNICI

VERIFICA SLP

PEREQUAZIONE (VEDI TAV.4*)

SLP= Terrano Via Triso MQ.1932.00X0.20= MQ.386.40

PDR 245/09

SLP= Sup. Coperto per Piano MQ.811.20X0.9= MQ.730.08

PDR 365/16

SLP= Sup. Coperto per Piano MQ.1340.08X0.9= MQ.1206.05

VERIFICA

SLP perequazione+SLP PDR 245/09=MQ.386.40+MQ.730.08=MQ.1.116.48
SLP PDR 245/09+SLP PDR 365/16=MQ.1.116.48+MQ.1206.05=MQ.89.57

PDR 245/09

PIANTA PIANO SOTTOTETTO

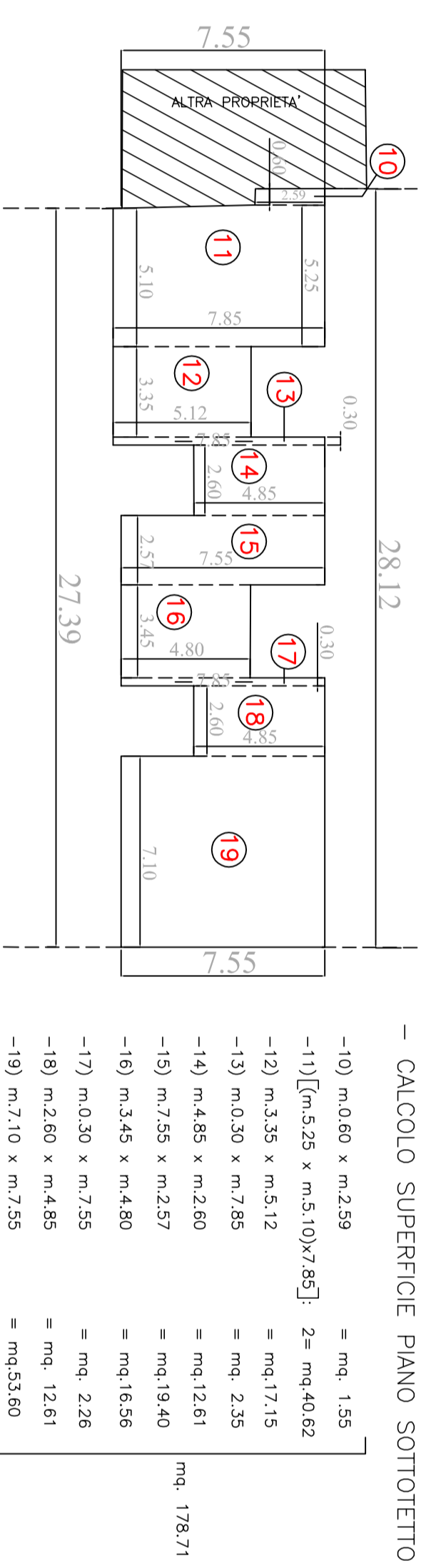

— CALCOLO SUPERFICIE PIANO SOTTOTETTO

- 10) m.0.80 x m.2.59 = mq. 2.07
- 11) (m.2.52 x m.3.07/2) = 2- mq.40.42
- 12) m.3.35 x m.5.12 = mq.17.15
- 13) m.0.30 x m.7.85 = mq. 2.35
- 14) m.4.85 x m.2.60 = mq.12.61
- 15) m.2.55 x m.2.57 = mq.6.54
- 16) m.3.45 x m.4.80 = mq.16.56
- 17) m.0.30 x m.2.55 = mq. 0.76
- 18) m.2.50 x m.4.85 = mq. 12.61
- 19) m.2.10 x m.2.55 = mq.5.40

PIANTA PIANO PRIMO

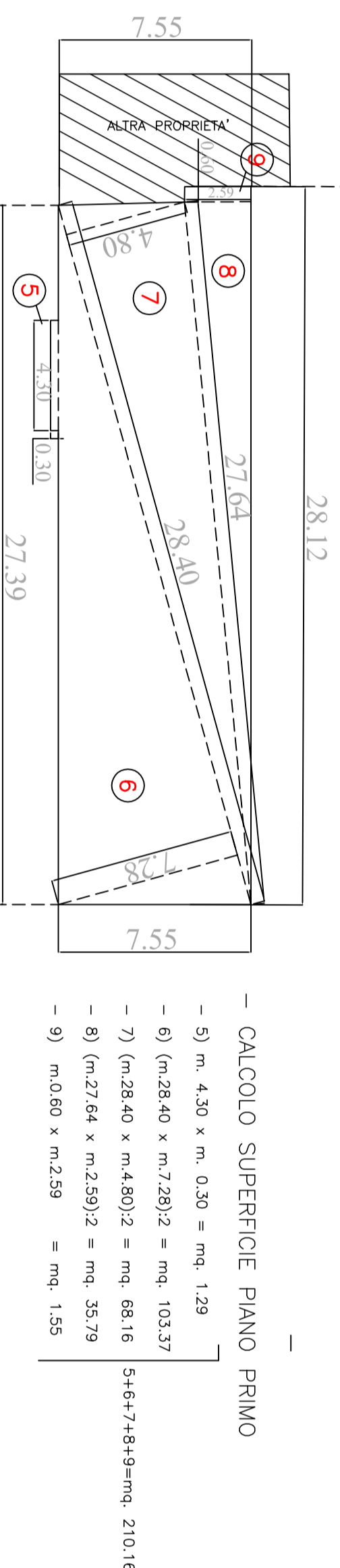

— CALCOLO SUPERFICIE PIANO PRIMO

- 1) m. 4.30 x m. 0.30 = mq. 1.29
- 2) (m.28.84 x m.2.30) = mq. 66.16
- 3) (m.28.84 x m.4.80) = mq. 138.37
- 4) (m.27.84 x m.2.30) = mq. 63.79
- 5) m.0.60 x m.2.39 = mq. 1.43

PIANTA PIANO TERRENO

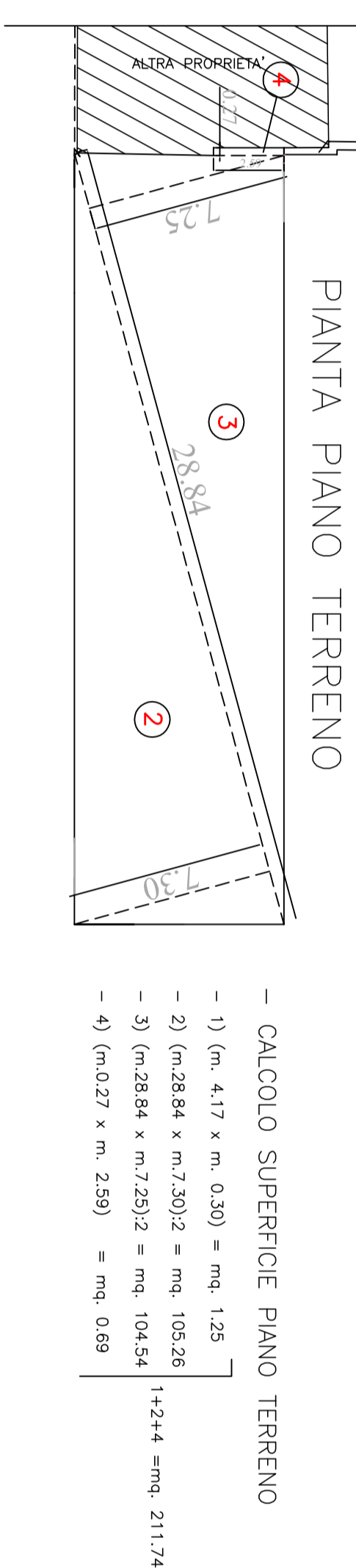

— CALCOLO SUPERFICIE PIANO TERRENO

- 1) (m. 4.17 x m. 0.30) = mq. 1.25
- 2) (m.28.84 x m.2.30) = mq. 66.16
- 3) (m.28.84 x m.2.30) = mq. 66.16
- 4) (m.0.27 x m. 2.39) = mq. 0.64

PIANTA PIANO SEMINTERRATO

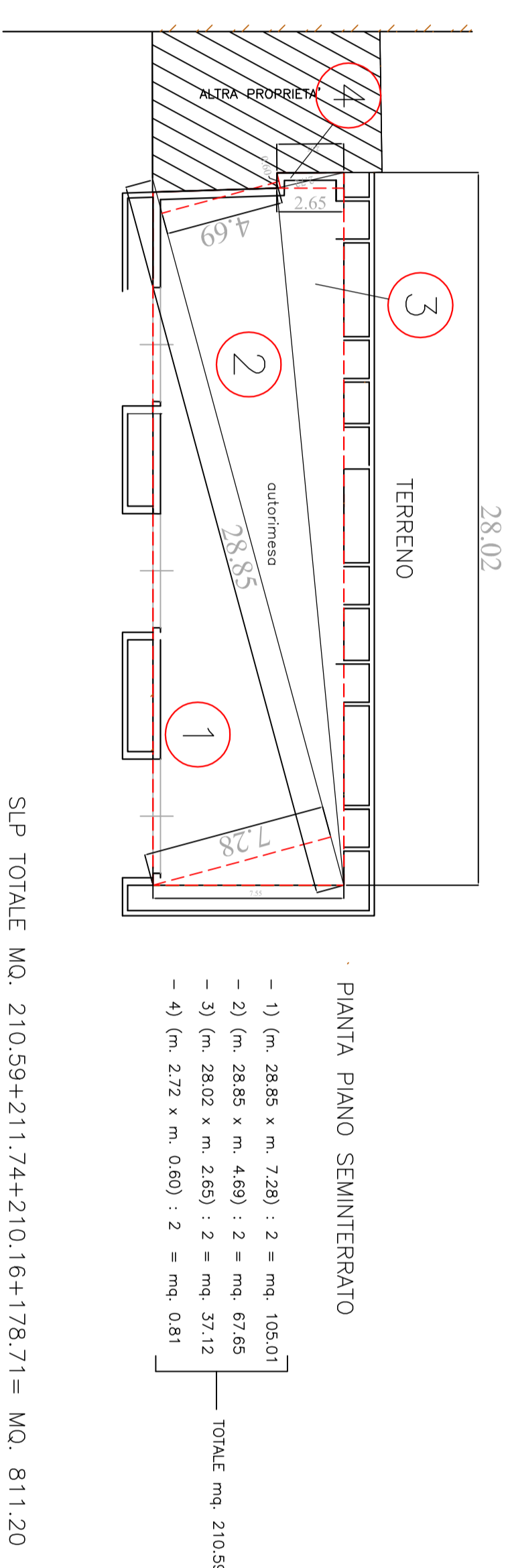

— CALCOLO SUPERFICIE PIANO SEMINTERRATO

- 1) (m. 28.85 x m. 2.30) = mq. 66.31
- 2) (m. 28.85 x m. 4.80) = mq. 138.37
- 3) (m. 28.02 x m. 2.45) = mq. 68.75
- 4) (m. 2.72 x m. 0.80) = mq. 2.18

SLP TOTALE MQ. 210.59+211.74+210.16+178.71= MQ. 811.20
MQ. 811.20X0.9=MQ.730.08

PDR 365/16

PIANTA PIANO SOTTOTETTO

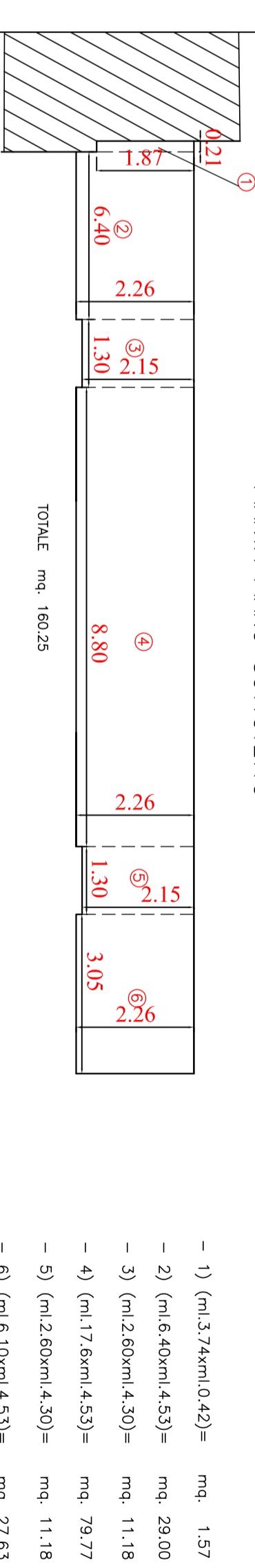

PIANTA PIANO SOTTOTETTO

- 1) (m.13.74x0.42)= mq. 5.77
- 2) (m.6.40x0.45)= mq. 2.88
- 3) (m.2.60x0.40)= mq. 1.04
- 4) (m.17.60x0.45)= mq. 7.92
- 5) (m.2.40x0.40)= mq. 0.96
- 6) (m.6.10x0.45)= mq. 2.74

PIANTA PIANO PRIMO

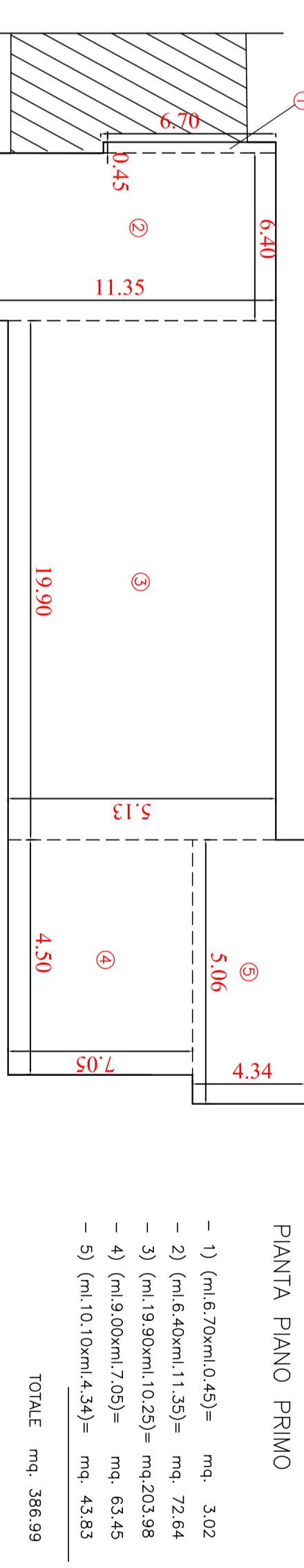

PIANTA PIANO PRIMO

- 1) (m.6.70x0.45)= mq. 3.02
- 2) (m.6.40x0.45)= mq. 2.88
- 3) (m.2.60x0.40)= mq. 1.04
- 4) (m.10.20x0.45)= mq. 4.59
- 5) (m.10.10x0.45)= mq. 4.55

PIANTA PIANO TERRENO

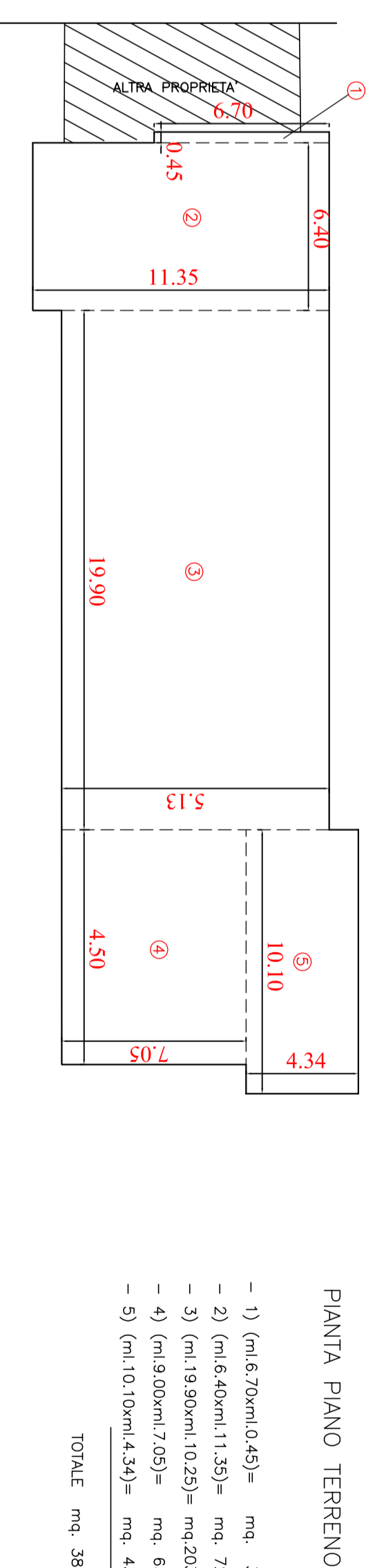

PIANTA PIANO TERRENO

- 1) (m.6.70x0.45)= mq. 3.02
- 2) (m.6.40x0.45)= mq. 2.88
- 3) (m.19.90x0.45)= mq.20.36
- 4) (m.6.00x0.45)= mq. 2.70
- 5) (m.10.10x0.45)= mq. 4.55

PIANTA PIANO INTERRATO

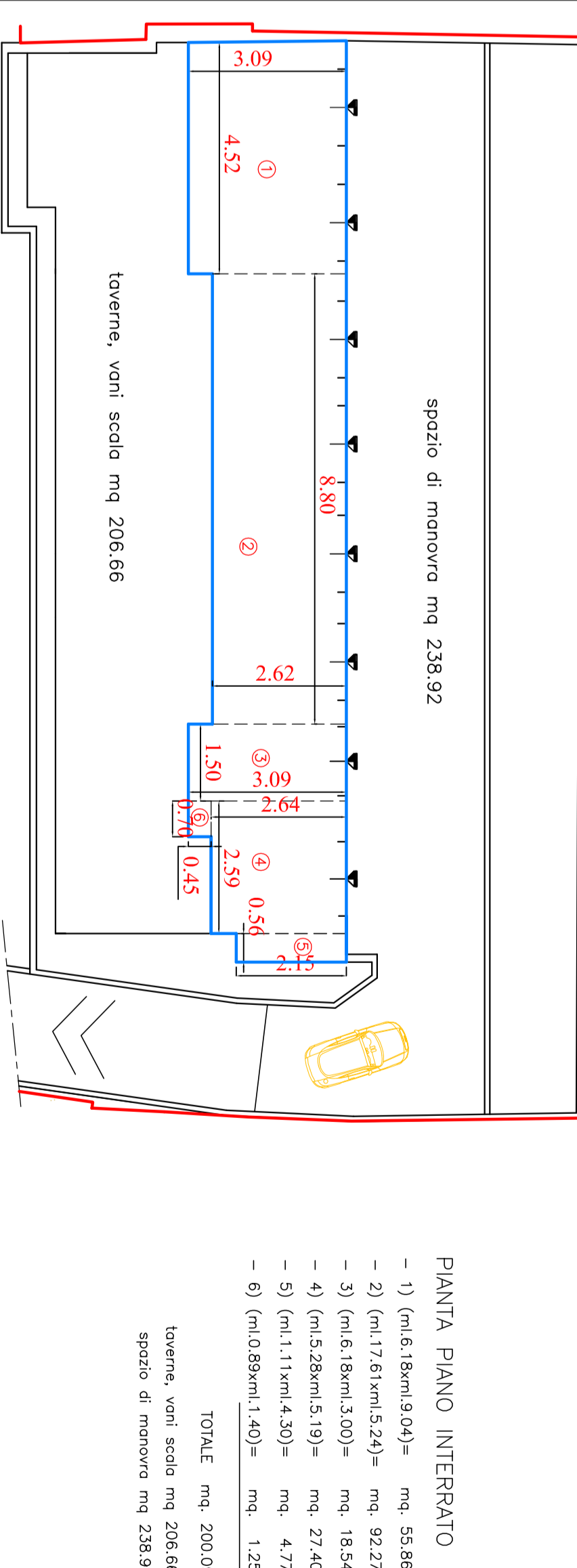

PIANTA PIANO INTERRATO

- 1) (m.6.18x0.45)= mq. 2.78
- 2) (m.17.61x0.55)= mq. 9.72
- 3) (m.6.18x0.50)= mq. 3.09
- 4) (m.2.28x0.50)= mq. 1.14
- 5) (m.2.17x0.50)= mq. 1.09
- 6) (m.0.80x0.45)= mq. 0.36

SLP TOTALE MQ. 200.09+205.66+386.99+386.99+160.33= MQ. 1340.06
MQ. 1340.06X0.9=MQ.1206.05