

PROPRIETA':

Franco Sanesi
c.f. SNSFNC30A27G999S

Giuliano Sanesi
c.f. SNSGLN33P29G999X

Paolo Sanesi
c.f. SNSPLA35M06G999C

PROGETTO:

studio **martini** arch. Paolo Martini

arch. Elena Martini

studio **b-arch** arch. Sabrina Bignami

arch. Alessandro Capellaro



STATO DI RILIEVO
scala 1:500

Calcolo Superficie Territoriale
Calcolo Superficie Lorda Esistente

data: 26.02.2014

SUPERFICIE TERRITORIALE

Piano terra

- A) $(63,20 + 62,20) \times 12,80 / 2 = 802,56$ mq
 - B) $(32,20 + 31,80) \times 12,80 / 2 = 409,60$ mq
 - C) $(58,80 + 57,25) \times 12,80 / 2 = 742,72$ mq
 - D) $(34,00 + 33,20) \times 13,00 / 2 = 436,80$ mq
-
- 2.391,68 mq

- E) $60,80 \times 19,40 = 1.179,52$ mq
 - F) $116,20 \times 15,35 = 1.783,67$ mq
-
- 2.963,19 mq

- 1) $33,75 \times 38,86 = 1.311,53$ mq
 - $36,63 \times 1,80 / 2 = - 32,96$ mq
 - $31,99 \times 5,43 / 2 = - 86,85$ mq
 - $33,75 \times 2,22 / 2 = - 37,46$ mq
-
- 1.154,26 mq

- 2) $1,50 \times 61,35 = 92,02$ mq
 - $(15,85 + 17,97) \times 36,46 / 2 = 616,53$ mq
 - $(12,63 + 14,44) \times 26,76 / 2 = 362,19$ mq
 - $42,20 \times 7,30 = 308,06$ mq
-
- 1.378,80 mq

Tot S.t. **7.887,93**

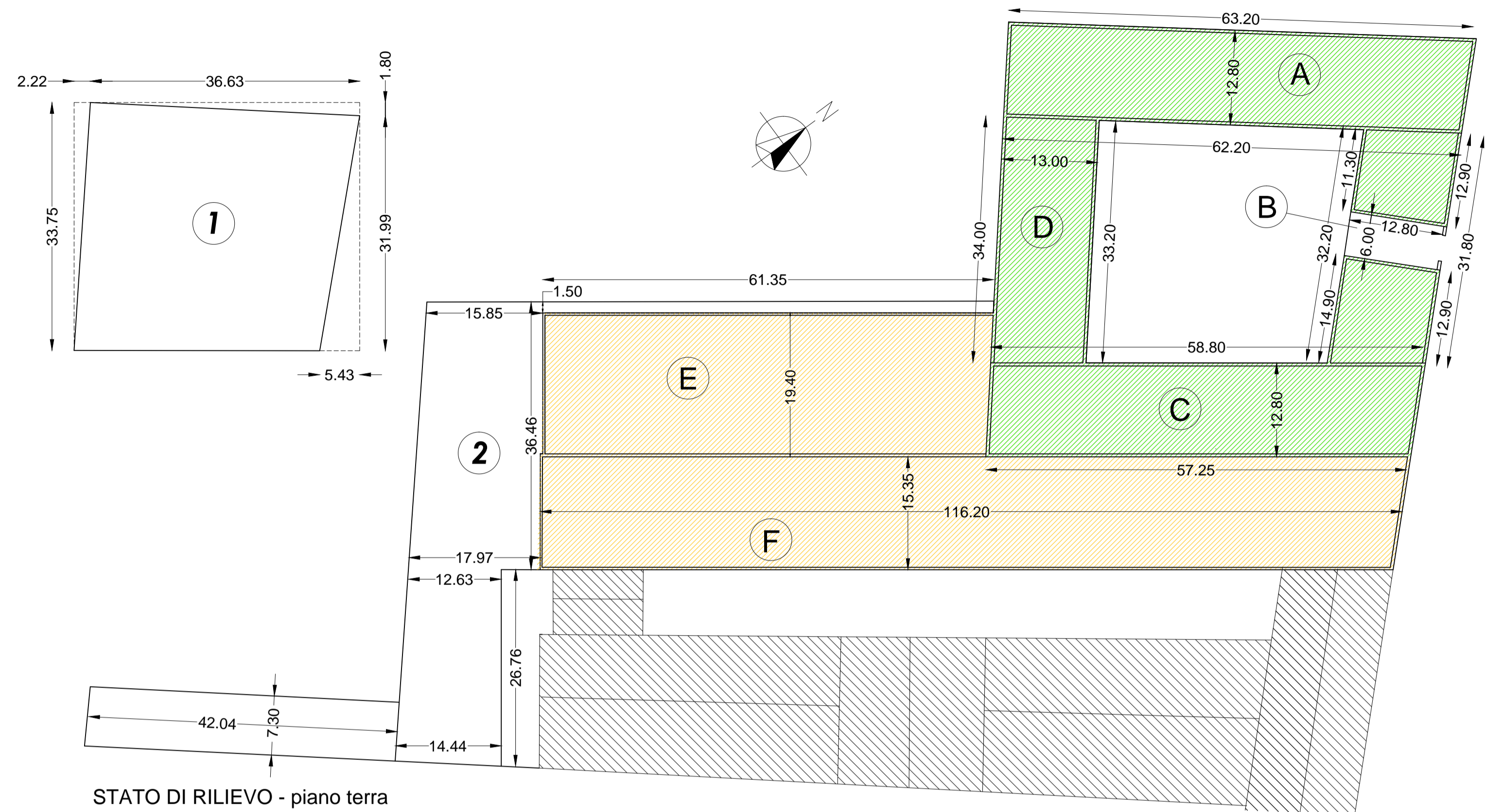

SUPERFICIE LORDA ESISTENTE

Piano terra

- A) $(63,20 + 62,20) \times 12,80 / 2 = 802,56$ mq
- B) $(32,20 + 31,80) \times 12,80 / 2 = 409,60$ mq
- $12,80 \times 6,00 = - 76,80$ mq
- C) $(58,80 + 57,25) \times 12,80 / 2 = 742,72$ mq
- D) $(34,00 + 33,20) \times 13,00 / 2 = 436,80$ mq
- 2.314,88 mq
- E) $60,80 \times 19,40 = 1.179,52$ mq
- F) $116,20 \times 15,35 = 1.783,67$ mq
- 2.963,19 mq

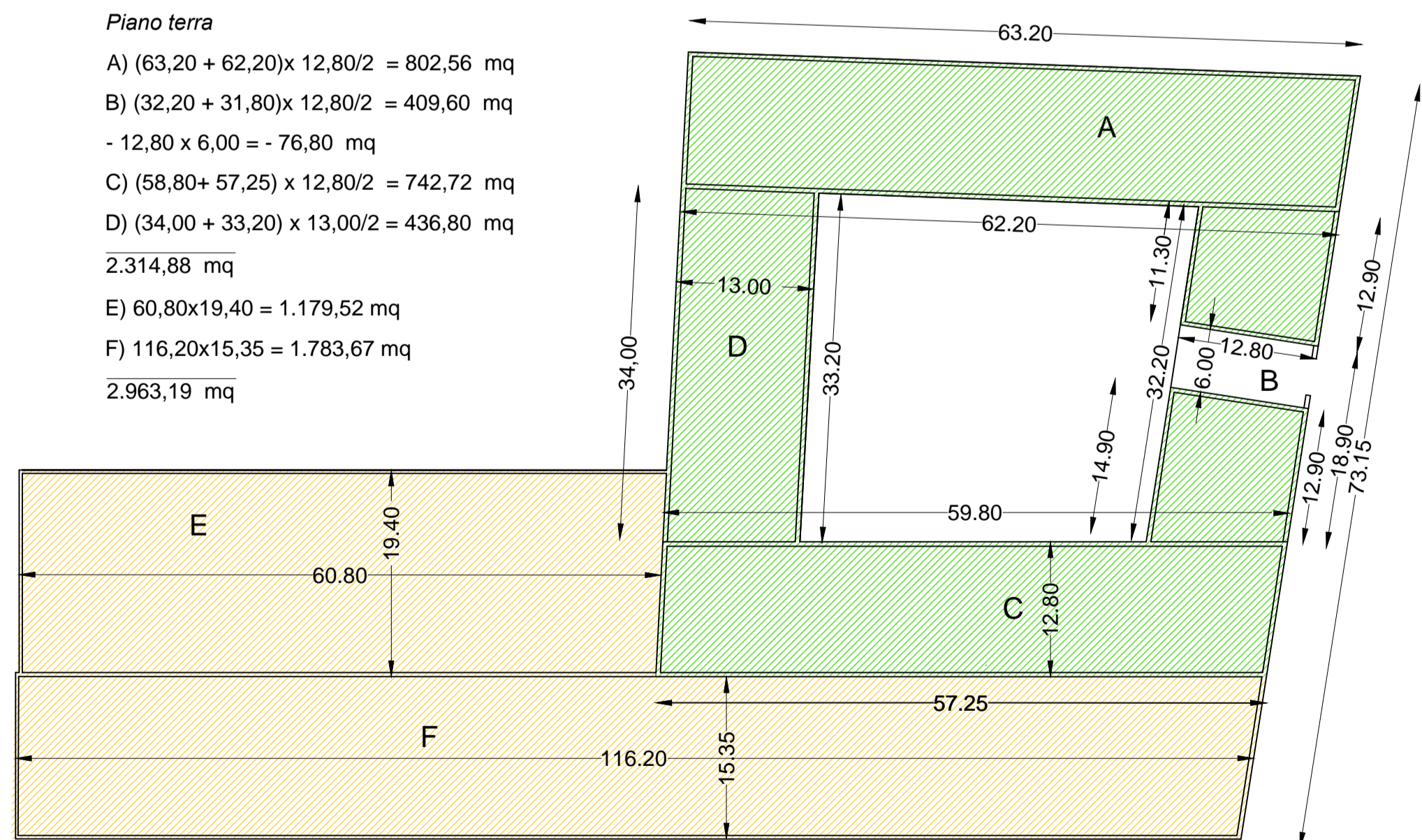

STATO DI RILIEVO - piano terra

Piano primo

- G) $(63,20 + 62,20) \times 12,80 / 2 = 802,56$ mq
- H) $(11,30 + 12,90) \times 12,80 / 2 = 154,88$ mq
- I) $(20,90 + 18,90) \times 12,80 / 2 = 254,7$ mq
- L) $(58,80 + 57,25) \times 12,80 / 2 = 742,72$ mq
- M) $(34,00 + 33,20) \times 13,00 / 2 = 436,80$ mq
- 2.391,68 mq
- N) $116,20 \times 15,35 = 1.783,67$ mq
- O) $60,80 \times 19,40 = 1.179,52$ mq
- 2.963,19 mq

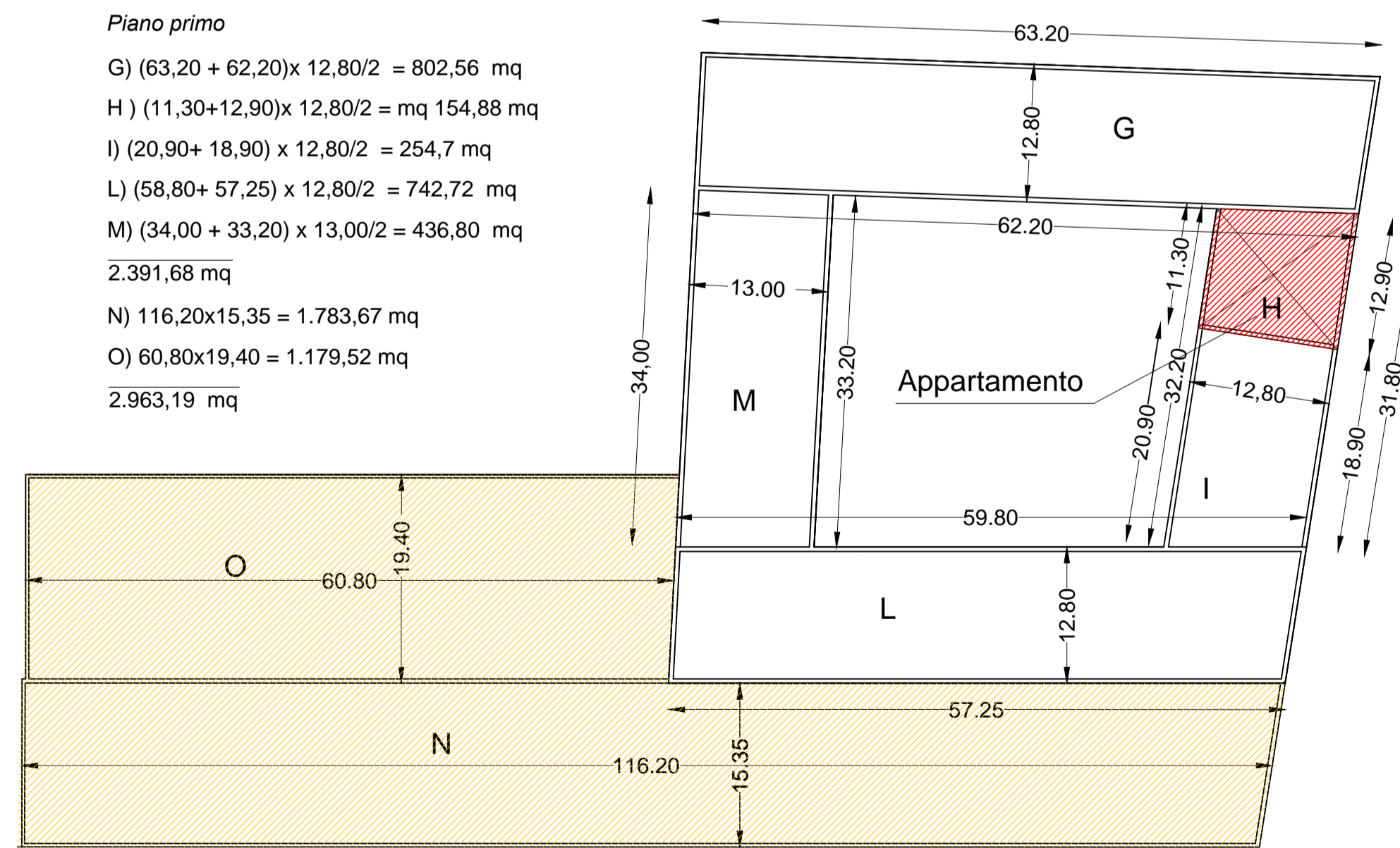

STATO DI RILIEVO - piano primo

Piano secondo

- P) $(32,20 + 31,80) \times 12,80 / 2 = 409,60$ mq

Superficie lorda totale **11.042,54** Mq

Superficie lorda totale escluso appartamento H
11.042,54 - 154,88 = 10.887,66 Mq

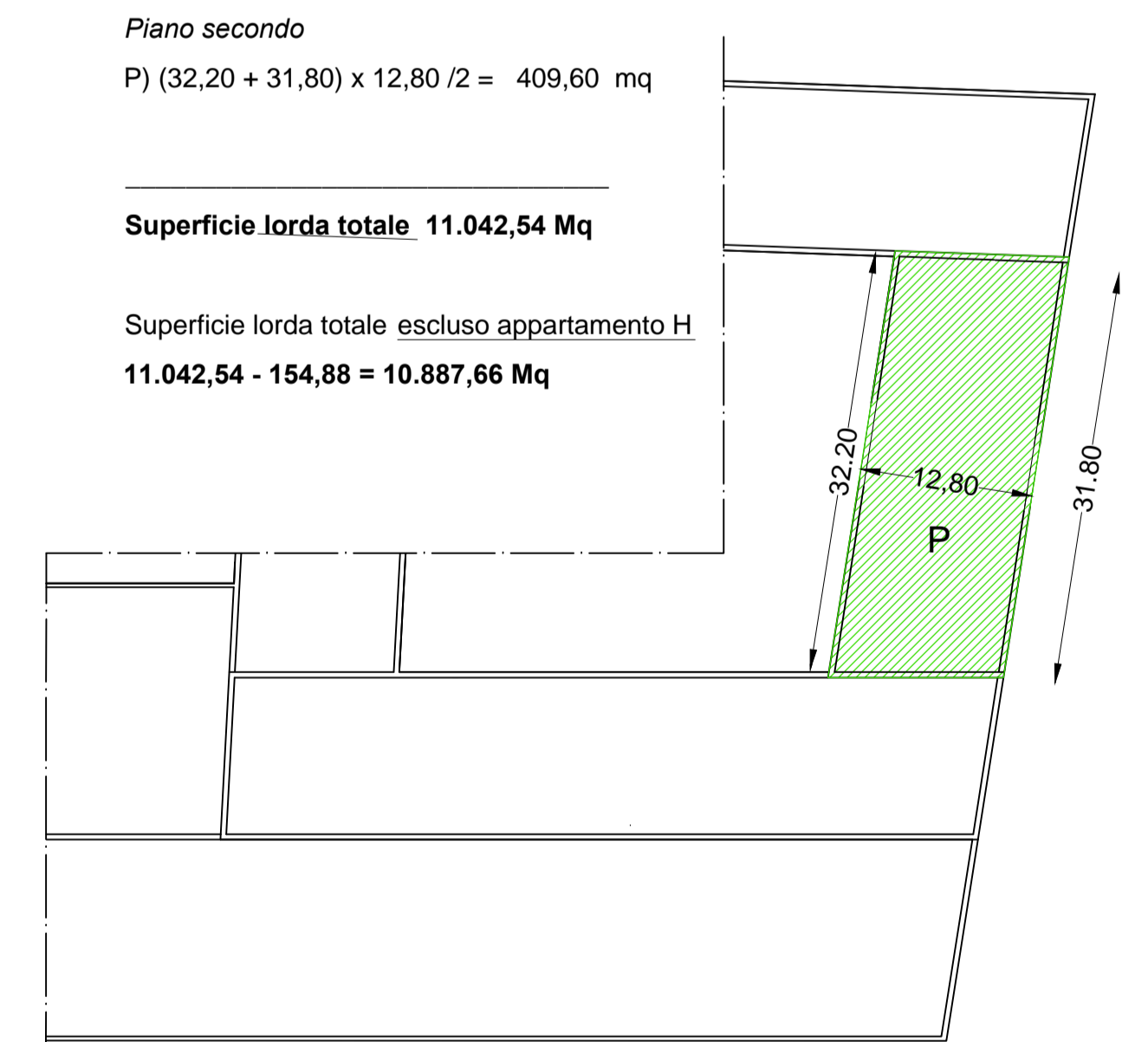

STATO DI RILIEVO - piano secondo